



ARTIST IMPRESSION ONLY. ASPEN FAÇADE AS ILLUSTRATED.

ECCO 15.2

LAND SIZE: 329.9m² | HOUSE: 141.35 Sq | SQUARES: 15.2Sq

\$890,900

ASPEN
FAÇADE
INCLUDED

LOT 4 GURNER AVENUE - AUSTRAL (MAPLE GROVE)

INCLUSIONS:

- ✓ 4 Bedrooms with Single Locked-up Garage
- ✓ Tiling to Porch, Entry, Kitchen, Family/Dining & Alfresco
- ✓ Carpet to Living & Bedrooms
- ✓ Natural gas package incl. Instantaneous HWS
- ✓ Fixed Site Costs & Basix Requirements
- ✓ Insulation to Ceiling & Walls (Except Garage)
- ✓ 2.59m Ceilings (Ground Floor Only)
- ✓ T2 Termite Treated Frame
- ✓ Perimeter Termite Protection
- ✓ Coloured concrete Driveway & Pathway to Porch
- ✓ Remote Control Panel Lift Garage Door
- ✓ Stone benchtop to Kitchen
- ✓ 600mm Westinghouse Appliances
- ✓ Alarm System
- ✓ 10 LED Downlights
- ✓ Fully Ducted Day/Night Air Conditioning

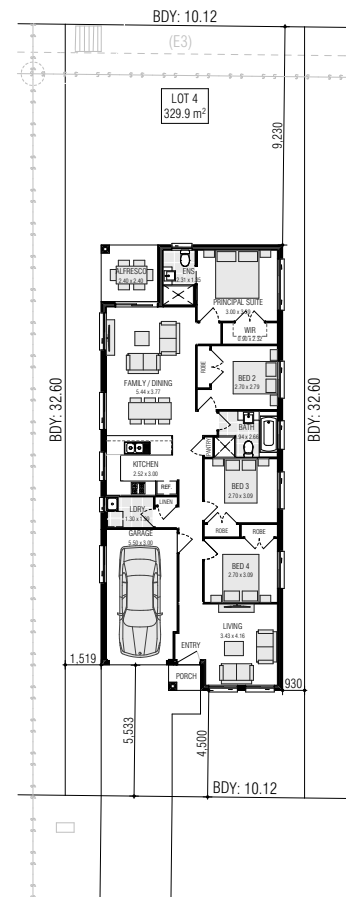

GURNER AVENUE
(E3) EASEMENT TO DRAIN WATER 1.2 & 1.5 WIDE



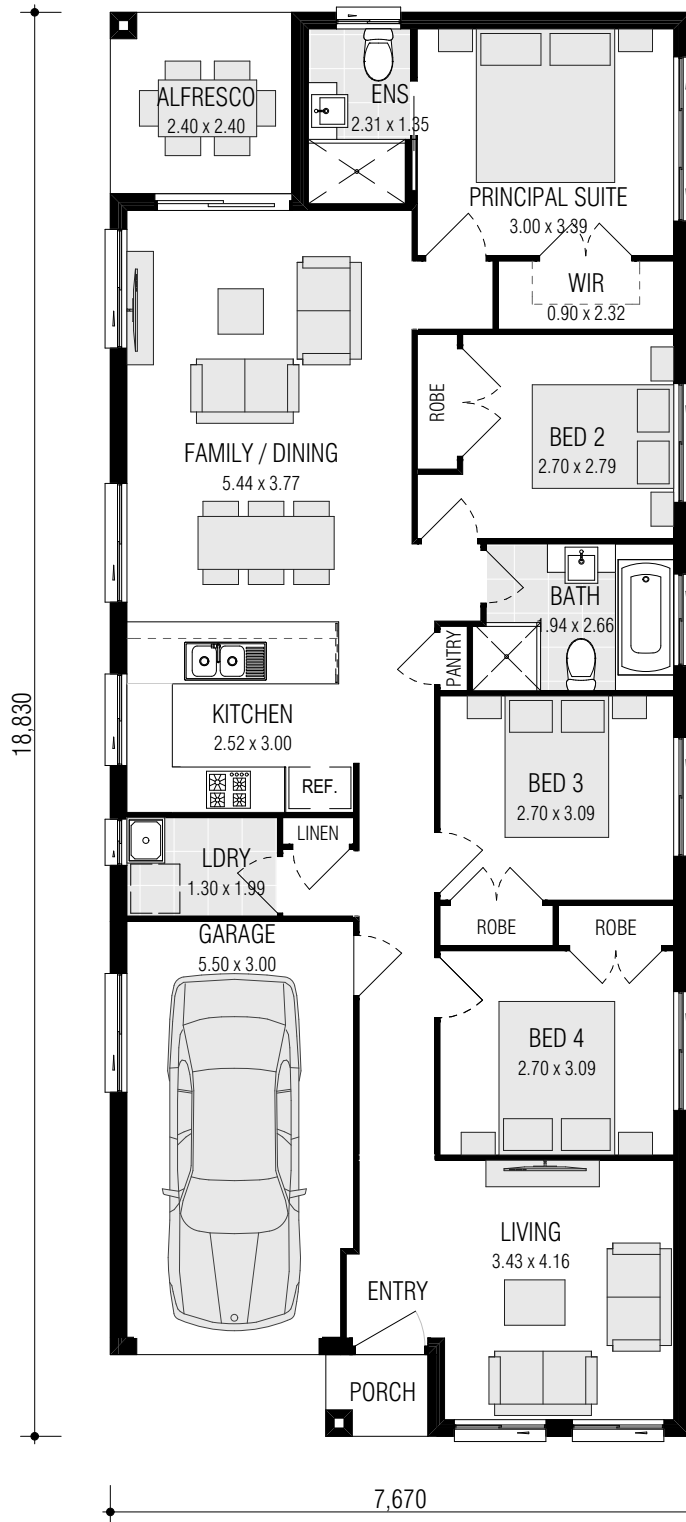

ECCO 15.2

FRONTAGE REQUIRED (MINIMUM): 9.53m
 HOUSE SIZE: 141.35 m²
 SQUARES: 15.2q
 DATE: 20/11/2023

DISCLAIMER: All plans, images and areas are indicative only. The finishes to the nominated design are to be used as a guide only. Purchases are advised to refer to the Land Contract and/or Builders Tender and Contract for precise dimensions, specifications and inclusions. Firststyle Homes reserves the right to change specifications, materials and suppliers without notice. B.L 113412C

Gross Areas	
Ground Floor	115.92
Garage	18.21
Alfresco	5.76
Porch	1.46
Totals	141.35 m²