



\$1,155,900

ARTIST IMPRESSION ONLY.

FIXED PRICE
House and land Package

LOT 1190 SHORTHORN STREET - NORTH WILTON

LAND SIZE: 543.40m² | HOUSE SIZE: 242.09m² | SQUARES: 26.1 Sq

CLARKSON 24.4 MOD SILVER LEVEL | AR,ITAGE MKIII FACADE

INCLUSIONS:

- Tiling to Verandah, Entry, Kitchen, Living/Dining & Alfresco
- Carpet to Bedrooms
- Electrical Package incl. Electric Hot Water Storage System
- Fixed Site Costs & Basix Requirements
- 2.59m Ceilings (ground floor only)
- T2 Termite Treated Frame & Perimeter Protection
- Coloured concrete Driveway & Pathway to Porch
- Remote Control Panel Lift Garage Door
- Stone benchtop to Kitchen
- Westinghouse Appliances
- Alarm System
- 15 LED Downlights
- Fully Ducted Day/Night Air Conditioning
- 6.6kW Solar Panel System & 5kW battery

INCLUSIVE PLUS

- ✓ Turf to front & rear
- ✓ Letterbox
- ✓ Planting to front yard
- ✓ Fencing to Rear & Side boundaries
- ✓ 1 x side Gate and fixed panel as required
- ✓ Washed pebble path to sides
- ✓ Flyscreens to all opening windows

Style.

PREMIUM UPGRADES



House and Land Packages is subject to the client entering into a Building agreement within the specified period stated in their Firststyle Homes Quotation. All prices are GST inclusive. Firststyle Homes reserves the right to change prices without notice. Items shown are indicative only and are not redeemable for cash or alternative items and may be subject to amendment without notice at the discretion of the builder. Price is fixed only once both Contract for Sale of Land and Building Contracts are exchanged. B.L.113412C

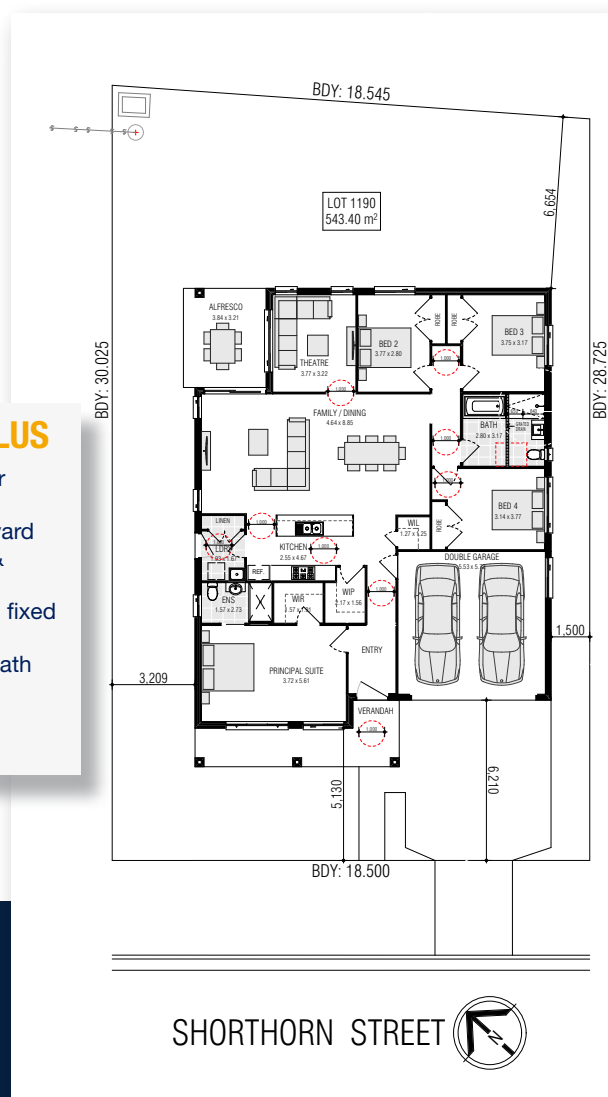

AGENT NAME

M: XXXX XXX XXX | Ph: XXXX XXXX

E: _____@firststyle.com.au

DISPLAY NAME

Display Address here



SHORTHORN STREET



