



  
MARSHALLWHITE  
ONE

G06/2 Constance Street  
Hawthorn East





## 'Constance': Superb Al fresco Apartment

This modern, two bedroom, ground-floor apartment blends a bold design initiative with premium appointments, plenty of space and a lovely al fresco flow, to deliver a clear statement in quality. As it opens to a large courtyard bathed in westerly and northerly sunshine, the home's open-plan kitchen / meals / living features integrated Miele appliances, stone bench tops and stunning mirrored splash backs as well as high square-set ceilings and broad Royal oak floors, whilst the bathroom, too, is impressive with a European laundry. Part of the boutique 'Constance' building with secure video entry, basement parking and elevator access, the home is highly secure and features robes in the bedrooms as well as ducted heating and cooling. Adjacent to beautiful Anderson Park, you will relish the ability to walk to Tooronga Shopping Centre, plus you have Burke Rd nearby, Camberwell Junction, all transport and freeway access to enhance your lifestyle.

G06-2constancestreet-hawthorneast.com 2 1 1

Auction Saturday 23rd September at 12.30pm

Bethany Wilkinson 0449 285 813

801 Glenferrie Road Hawthorn

Jack Moss 0439 378 954

9822 9999 mwone.com.au

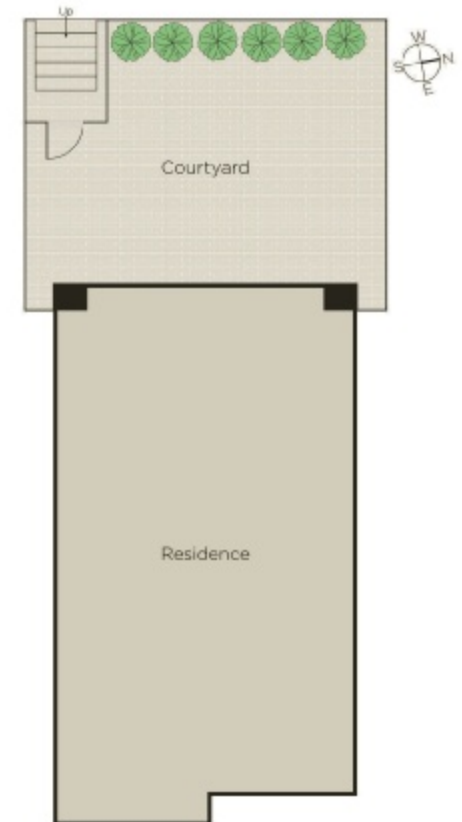

  
MARSHALLWHITE  
ONE

Disclaimer: Information provided is believed to be accurate as at the date of printing, no responsibility is taken for any errors or omissions. It is your responsibility to obtain independent, professional advice. Personal information collected from you is for security purposes to contact you should the property sell prior to auction. We may use this information to provide you with other real estate services including referrals to authorized financial services providers. Visit our website at [www.mwone.com.au](http://www.mwone.com.au) for our privacy policy.