



MARSHALLWHITE

93 Park Street
St Kilda West



"Corowa"

Set on a deep allotment (50m approx.) this impeccably stylish solid brick single level Period residence's spacious dimensions deliver enviable family lifestyle appeal near the beach, restaurants, shops, trams and schools.

Baltic pine floors and high ceilings define the hallway, formal living room (open fire), gourmet kitchen and generous dining area. Spacious living room opens to a private garden with heated pool. Two bedrooms with robes and stylish en-suites are complemented by a third double bedroom (robe), chic bathroom and freestanding studio/4th bedroom with en-suite. Includes off street parking.

93parkstreet-stkildawest.com

4 4 1

Auction Saturday 3rd March at 12.30pm

Justin Holod
0411 669 161

Sarah Wood
0408 902 827

Georgia Whitford
0434 827 563

MARSHALLWHITE

101 Dundas Place, Albert Park

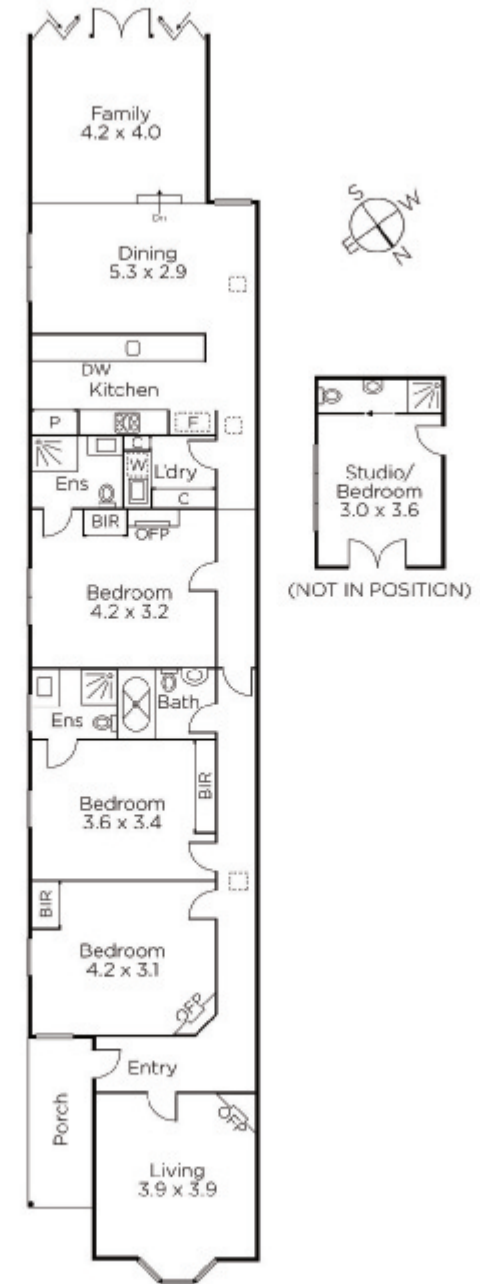

Disclaimer: Information provided is believed to be accurate as at the date of printing, no responsibility is taken for any errors or omissions. It is your responsibility to obtain independent, professional advice. Personal information collected from you is for security purposes and to contact you should the property sell prior to auction. We may use this information to provide you with other real estate services including referrals to authorised financial services providers. Visit our website at www.marshallwhite.com.au for our privacy policy.