



bc
BANK OF CALIFORNIA
COMMERCIAL BANK



MARSHALLWHITE
ONE

9/12 Auburn Grove
Hawthorn East



Blue Chip, Leafy Living or Investing

Well-presented and maintenance free, the home enjoys attractive leafy vistas from the first floor/top floor of this boutique block of only nine and allows city workers to park their car at the rear while enjoying effortless city-commuting. This one bedroom apartment will certainly appeal to investors and first home buyers keen on securing a blue ribbon inner-Eastern entry. Accessed by intercom entry, the home feels remarkably private, as a sparkling kitchen/meals and separate lounge all enjoy lush garden outlooks. The bedroom is large with enough room for a desk, whilst the ensuite bathroom is equipped with laundry facilities. All the boxes have been ticked in this premium tree-lined setting that allows you to wander down to Auburn Village for a coffee or some café culture, whilst Auburn Railway Station, Riversdale Rd trams, Camberwell Junction and Swinburne University are all walkable as well.

9-12auburngrove-hawthorneast.com



Auction Saturday 6th April at 10.30am

Danny See 0402 533 853

Kane Penhalluriack 0406 556 445

801 Glenferrie Road Hawthorn

9822 9999 mwone.com.au

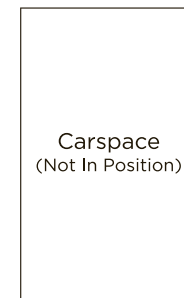
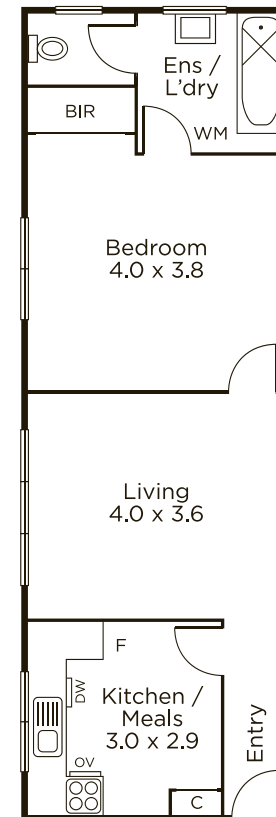

Disclaimer: Information provided is believed to be accurate as at the date of printing, no responsibility is taken for any errors or omissions. It is your responsibility to obtain independent, professional advice. Personal information collected from you is for security purposes to contact you should the property sell prior to auction. We may use this information to provide you with other real estate services including referrals to authorized financial services providers. Visit our website at www.mwone.com.au for our privacy policy.