



  
MARSHALLWHITE

9/109 Asling Street  
Brighton







## Hideaway Townhouse for Easy Living

Discover an idyllic 3-bedroom townhouse, where low-maintenance living is stylish, centrally located and metres from a bike and walking trail. Positioned at the rear of a boutique development, this is ready for you or your tenant to enjoy a north-facing living room, three double bedrooms, and a Smeg and stone kitchen. The difference is in the design, with decked areas outside the living zone and master bedroom, private entry, and two basement car parks. Head for the Elster Creek bike path and you can be at Elwood's cafes, trains and Martin St's shops in minutes. Impressive rental returns, or make this your Brighton home.

9-109aslingstreet-brighton.com



Auction Saturday 3rd March at 10.30am

Kate Fowler  
0418 418 385

Robin Parker  
0409 336 282

  
MARSHALLWHITE

225 Bay Street, Brighton

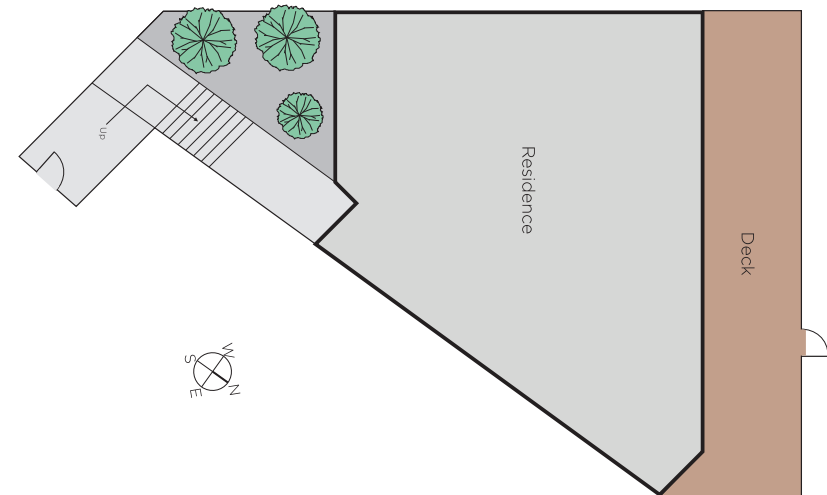

Disclaimer: Information provided is believed to be accurate as at the date of printing, no responsibility is taken for any errors or omissions. It is your responsibility to obtain independent, professional advice. Personal information collected from you is for security purposes and to contact you should the property sell prior to auction. We may use this information to provide you with other real estate services including referrals to authorised financial services providers. Visit our website at [www.marshallwhite.com.au](http://www.marshallwhite.com.au) for our privacy policy.