



MARSHALLWHITE
ONE

8/236 Wattletree Road
Malvern



Designer Edge in a Garden Sanctuary

Distinguished by the shelter of its private garden oasis and its sleek sense of sophistication, this generously proportioned and immaculately presented one bedroom apartment is an irresistible opportunity for first home buyers and astute investors to gain an easily maintained foothold in the thriving heart of Malvern. Polished concrete floors create an immediate visual impact in the home's kitchen/meals/living which is an impressive domain of style and comfort with a gas log fire, whilst the bedroom is spacious with robes and ensuite access to the bathroom/laundry. Both reassuringly secure and surprisingly private with intercom entry, the home also offers the prize of carport parking. Conveniently situated within walking distance of Glenferrie Rd, Malvern Central Shopping Centre and Central Park, the local cafes, restaurants and shopping are set to enhance your lifestyle, whilst there is plenty of public transport nearby as well.

8-236wattlestreeroad-malvern.com

1 1 1

Auction Saturday 2nd December at 10.30am

Matt Giulieri 0407 851 206

1111 High Street Armadale

Jack Nicol 0400 774 428

9822 9999 mwone.com.au

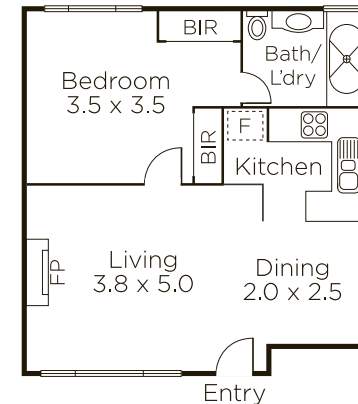

MARSHALLWHITE
ONE

Disclaimer: Information provided is believed to be accurate as at the date of printing, no responsibility is taken for any errors or omissions. It is your responsibility to obtain independent, professional advice. Personal information collected from you is for security purposes to contact you should the property sell prior to auction. We may use this information to provide you with other real estate services including referrals to authorized financial services' providers. Visit our website at www.mwone.com.au for our privacy policy.