



MARSHALLWHITE  
ONE

8/11-13 Wattletree Road  
Armadale



## Consummate Contemporary Comfort

Set in a boutique block in the heart of Armadale and filled with natural light and loaded with contemporary luxury, the focus of this spacious two bedroom plus study and or third bedroom apartment rests firmly on providing state-of-the-art surroundings that meet today's needs with elegance and ease. Lift access from lovely entrance foyer. The apartment itself comprises large central living/dining areas with superb stone and stainless steel kitchen, an alluring north-facing terrace, an outdoor asset also accessed by a generous study/additional living. Main bedroom features en suite and its own terrace while generous second bedroom enjoys beautiful spa bathroom. Separate laundry, heating/cooling, video security, secure basement parking for two cars and storage. Close to Malvern Central, High Street shopping precinct & Glenferrie Road!

8-11-13wattlereeroad-armadale.com

3 2 2

### Private Sale

Matt Giulieri 0407 851 206

Madeline Kennedy 0411 873 913

1111 High Street Armadale

9822 9999 mwone.com.au

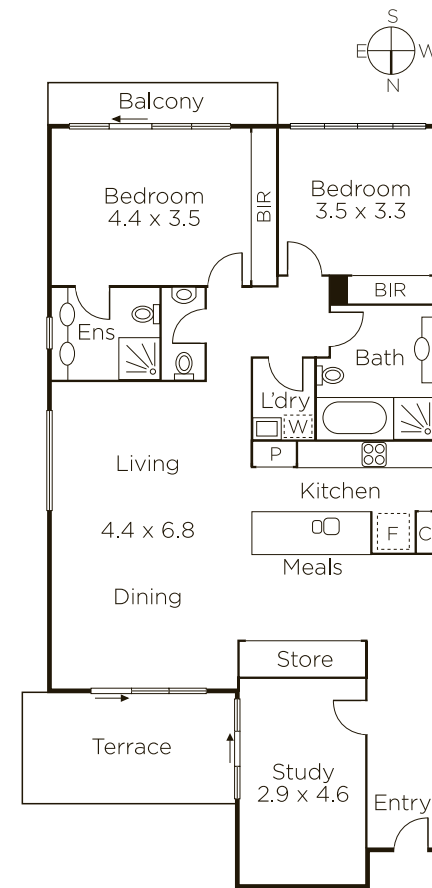

  
**MARSHALLWHITE**  
**ONE**

Disclaimer: Information provided is believed to be accurate as at the date of printing, no responsibility is taken for any errors or omissions. It is your responsibility to obtain independent, professional advice. Personal information collected from you is for security purposes to contact you should the property sell prior to auction. We may use this information to provide you with other real estate services including referrals to authorized financial services providers. Visit our website at [www.mwone.com.au](http://www.mwone.com.au) for our privacy policy.