



MARSHALLWHITE
ONE

8 Hallcroft Place
Hawthorn East

8



Pretty Period Pride with a Junction Lifestyle

A pretty, streamlined and easily-maintained inner-urban retreat in a peaceful cul de sac within easy walking distance of Camberwell Junction, this beautifully renovated and classical, two bedroom, brick period home is larger than an apartment and with a delightful al fresco flow. Pristine designer panache highlights an open-plan kitchen / meals / living equipped with SMEG appliances, stunning stone benches as it enjoys a light-loving flow to the home's attractive paved courtyard. Like a breath of fresh air, the home also features rich polished timber floors, fine period detail, robes and reverse cycle air conditioning as well as a separate storage room/laundry. From this terrific position, it is just a short stroll to all the cafes, restaurants, shops and even cinemas we love in Camberwell Junction, plus there are city-bound trams and trains nearby for the ultimate inner-urban lifestyle. Parking permits available subject to council approval.

8hallcroftplace-hawthorneast.com

2 1

Auction Saturday 7th October at 9.30am

Danny See 0402 533 853

Todd Braggins 0424 552 238

801 Glenferrie Road Hawthorn

9822 9999 mwone.com.au

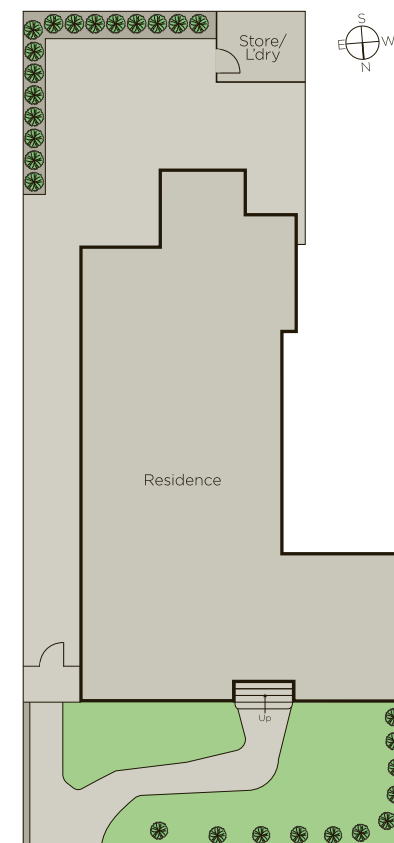
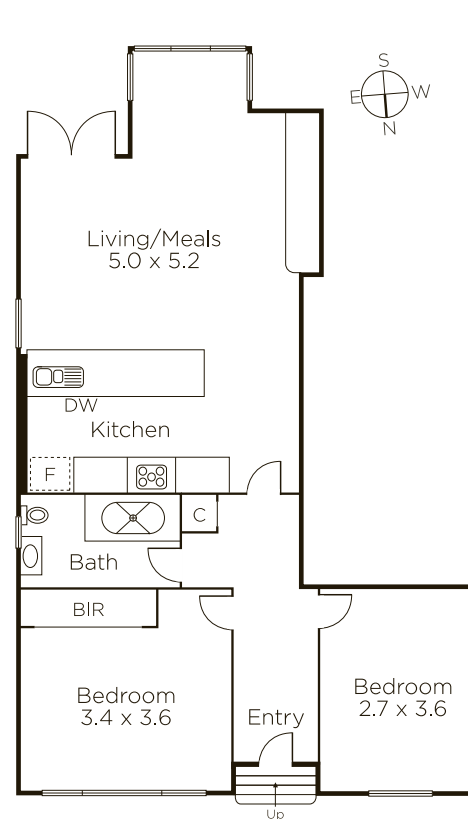

MARSHALLWHITE
ONE

Disclaimer: Information provided is believed to be accurate as at the date of printing, no responsibility is taken for any errors or omissions. It is your responsibility to obtain independent, professional advice. Personal information collected from you is for security purposes to contact you should the property sell prior to auction. We may use this information to provide you with other real estate services including referrals to authorized financial services' providers. Visit our website at www.mwone.com.au for our privacy policy.