



MARSHALLWHITE  
ONE

7/6-8 Hotham Street  
Mont Albert



## Secure, North-facing, Al fresco Haven

This incredibly private, spacious and modern, 3 bedroom townhouse is one of only twelve, with an enviable northern orientation. Timelessly presented with timber cabinetry and stainless steel appliances, the kitchen overlooks a vast meals/living room with doors that open to a broad paved courtyard. Bathed in northerly sun and surrounded by trees, the promise here is of pleasant al fresco living and home entertaining. The bedrooms are all upstairs with substantial robes; the master is large enough to accommodate a desk, whilst also enjoying semi-ensuite access to the bathroom. Additional features include a double carport, secure intercom entry, a powder room, laundry, central heating and volumes of storage. Just a relaxed walk from all the cosmopolitan shopping, eateries and cafes of Box Hill Central, plus you have plenty of local buses, city-bound trams and trains, as well as great local parks.

7-6-8hothamstreet-montalbert.com

3 2 2

Auction Saturday 14th December at 10.30am

Danny See 0402 533 853

Stuart Evans 0402 067 710

801 Glenferrie Road Hawthorn

9822 9999 mwone.com.au

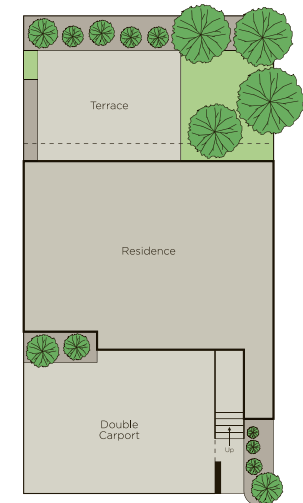

MARSHALLWHITE  
ONE

Disclaimer: Information provided is believed to be accurate as at the date of printing, no responsibility is taken for any errors or omissions. It is your responsibility to obtain independent, professional advice. Personal information collected from you is for security purposes to contact you should the property sell prior to auction. We may use this information to provide you with other real estate services including referrals to authorized financial services providers. Visit our website at [www.mwone.com.au](http://www.mwone.com.au) for our privacy policy.