



MARSHALLWHITE  
ONE

7/29 Rathmines Road  
Hawthorn East



## Cool, Al fresco Townhouse

Set towards the rear of a block of only eight - predominantly villas - this lovely, two bedroom townhouse presents a cool north-facing al fresco charm in a highly central location.

Highlighting rich polished timber floors, stone benches and stainless steel appliances, the kitchen and semi-attached lounge/dining enjoy a seamless flow to the home's generous and sun-drenched entertainers' deck. Both bedrooms are carpeted with one offering generous robes, plus there is a large bathroom with separate WC, as well as a European laundry in the kitchen, reverse cycle air conditioning and a highly convenient carport. Just moments from Auburn Village, Burwood Rd and Burke Rd, your selection of local cafes, restaurants and shops is both diverse and almost limitless, plus you have Auburn Train Station, great parks and Camberwell Junction just moments away.

7-29rathminesroad-hawthorneast.com 2 1 1

Auction Saturday 3rd March at 3pm

Bethany Wilkinson 0449 285 813

Jack Moss 0439 378 954

801 Glenferrie Road Hawthorn

9822 9999 mwone.com.au

  
MARSHALLWHITE  
ONE

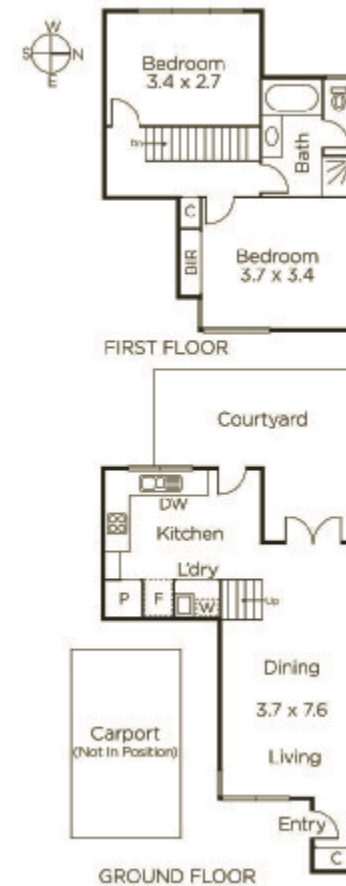

Disclaimer: Information provided is believed to be accurate as at the date of printing, no responsibility is taken for any errors or omissions. It is your responsibility to obtain independent, professional advice. Personal information collected from you is for security purposes to contact you should the property sell prior to auction. We may use this information to provide you with other real estate services including referrals to authorized financial services providers. Visit our website at [www.mwone.com.au](http://www.mwone.com.au) for our privacy policy.