



MARSHALLWHITE

7 Byron Street
Canterbury





Edwardian Charm, Enviably Location

Completely enchanting, this character-filled Edwardian residence delivers immediately appealing family living in a coveted leafy location offering close proximity to a range of schools, Riversdale station and Park, Maling Road Village, Riversdale Road trams and the Anniversary Trail.

Superbly oriented to maximize northern light, the generously proportioned living and dining room featuring timber floors and a wood fire heater and served by a well-appointed country style kitchen, opens to the lush north-oriented private garden. Three double bedrooms are complemented by a separate living room or fourth bedroom, a study and two bright bathrooms.

Immaculately presented throughout but also offering scope to update or rebuild (STCA), it includes a laundry, solar hot water, water tank and carport.

7byronstreet-canterbury.com

3  2  2 

Auction Saturday 6th May at 10.30am

Duane Wolowiec 0418 567 581

Daniel Williams 0402 182 704

Stuart Evans 0402 067 710

801 Glenferrie Road Hawthorn

marshallwhite.com.au

MARSHALLWHITE

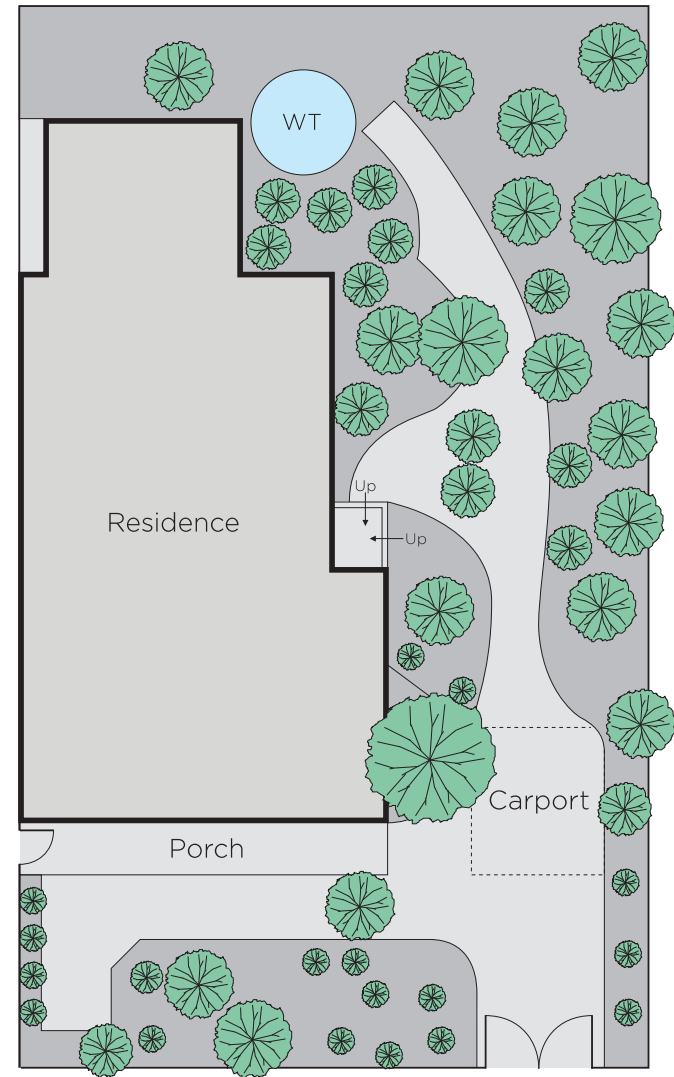
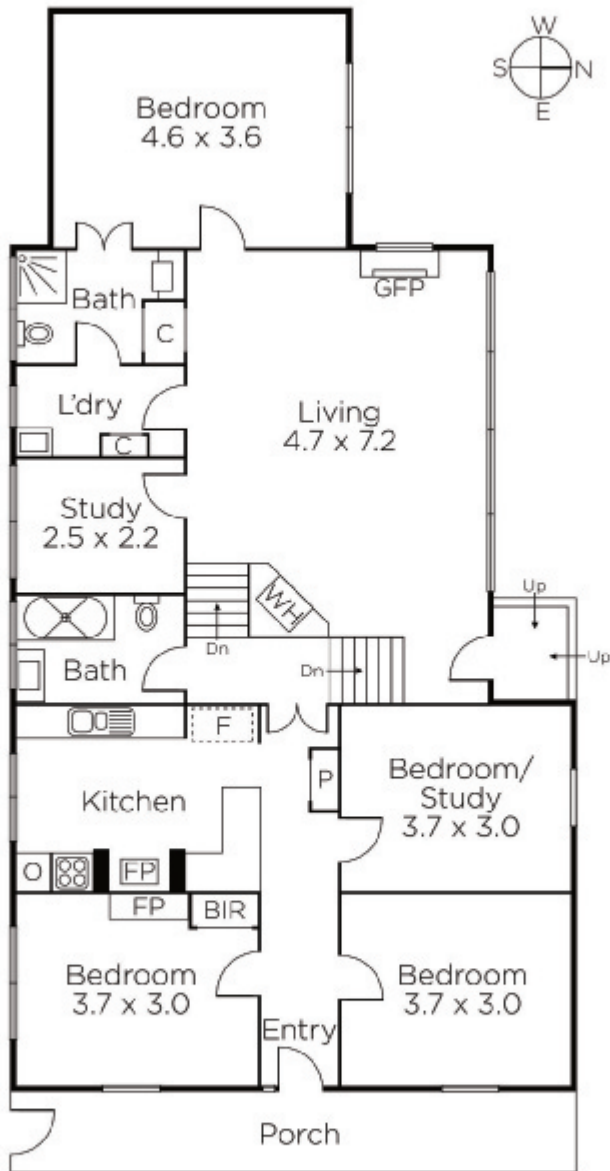

Disclaimer: Information provided is believed to be accurate as at the date of printing, no responsibility is taken for any errors or omissions. It is your responsibility to obtain independent, professional advice. Personal information collected from you is for security purposes and to contact you should the property sell prior to auction. We may use this information to provide you with other real estate services including referrals to authorised financial services' providers. Visit our website at www.marshallwhite.com.au for our privacy policy.