



CHIRNSIDE PARK 7 Allambi Road

**Jellis
Craig**

CHIRNSIDE PARK

7 Allambi Road

3  2  3  2  1 

Robin Boyd beauty, Yarra Valley views

On the edge of the Yarra Valley commanding sweeping ranges views, the Blott House (1956) is innovative Robin Boyd-designed brilliance of magnificent mid-Century authenticity amidst expansive Ellis Stones' inspired garden. Introduced by a striking window-wall façade, this sensational modernist residence is a remarkable discovery on 1,965 sq. metres (approx.) with a massive rear garden offering infinite space for sympathetic extension and pool. Easily accessing wineries, the city and amenities, this beautifully composed home features lounge (OFP) and dining areas, upstairs living, study or 3rd bedroom, 2 large downstairs bedrooms, updated kitchen, 2 bathrooms, ducted heating, alfresco terrace and garage.

www.7allambiroad-chirnsidepark.com

AUCTION Saturday 25th March at 3pm

INSPECT Thursday & Saturdays as advertised or by appointment

LAND 1,965 sqm approx.

CONTACT Belinda Anderson 0413 811 991
Rebecca Scanlon 0431 011 811

OFFICE Hawthorn 9810 5000

WEB jelliscraig.com.au

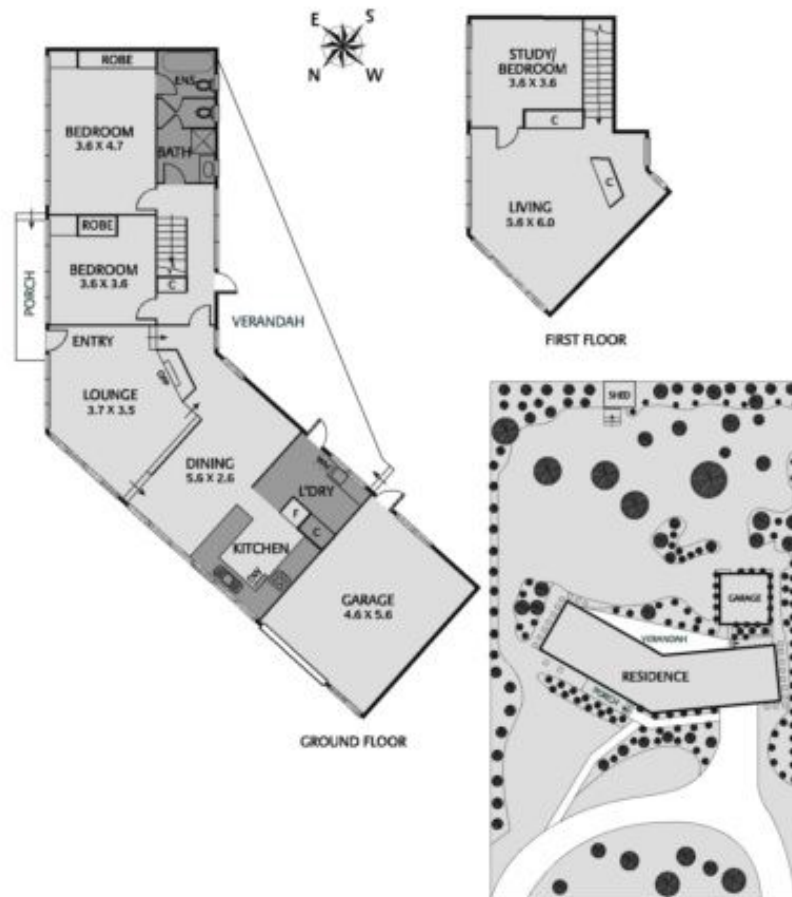

Disclaimer The measurements provided of the land and/or property may not be 100% accurate. In order to satisfy yourself of the exact dimensions of the property/land/or of each room, we advise you to conduct your own measurements and/or engage the services of a licensed surveyor. Responsibility for any omissions or errors contained herein is expressly denied. Jellis Craig (Hawthorn) and Company Pty Ltd ABN 77 603 848 264, Licensed Estate Agents, Auctioneers and Property Managers.