



C
4-6
S

MARSHALLWHITE
699 Malvern Road
Toorak



Prime Opportunity, Perfectly Positioned

On the corner of a cul de sac near Hawksburn Village, Toorak station, Orrong Park & schools, a more perfect location would be hard to find. Enjoying northern orientation, this captivating Edwardian residence provides immediate family enjoyment & outstanding scope to redevelop (STCA). Baltic pine floors & high ceilings define the arched hall leading to generous sitting & dining rooms, living room & modern kitchen opening to the private north garden. The main bedroom with en-suite is accompanied by three additional bedrooms & bathroom. Includes alarm, video intercom, laundry, garage & auto gate. Land size: 390sqm (approx)

699malvernroad-toorak.com

4 2 1

Auction Saturday 14th October at 3.30pm

Michael Martin 0478 011 216

John Manton 0411 444 930

1111 High Street Armadale
marshallwhite.com.au

MARSHALLWHITE

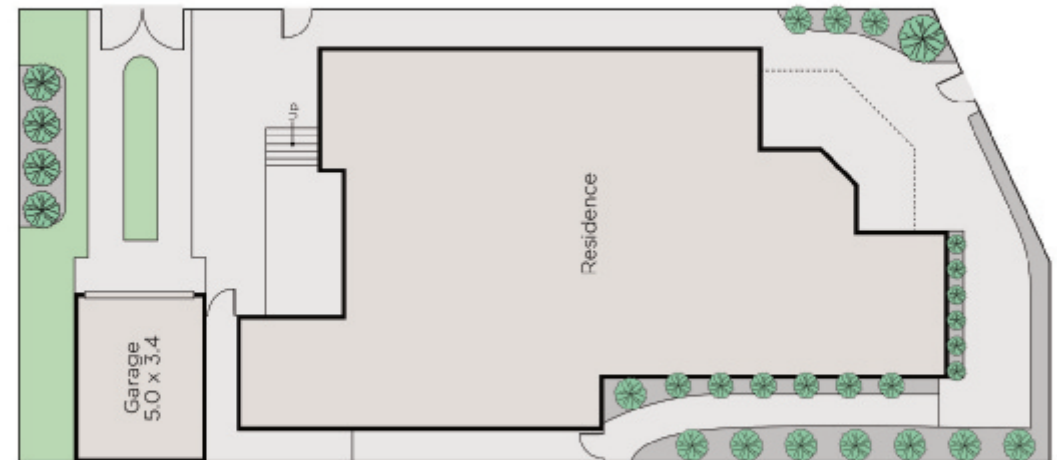

Disclaimer: Information provided is believed to be accurate as at the date of printing, no responsibility is taken for any errors or omissions. It is your responsibility to obtain independent, professional advice. Personal information collected from you is for security purposes and to contact you should the property sell prior to auction. We may use this information to provide you with other real estate services including referrals to authorised financial services' providers. Visit our website at www.marshallwhite.com.au for our privacy policy.