



MARSHALLWHITE

69 Wright Street  
Middle Park





## Brick Edwardian with Two Street Frontages

Tree lined street moments from Middle Park Village and the Beach creates the setting for this period brick residence immediately liveable with scope to improve on 208sqm approx. of land. An arched hallway entrance leads to two double bedrooms, a central bathroom and informal living area with light well. A functioning kitchen services an expansive open plan living/dining with fireplace, vaulted ceilings and skylight. The lush courtyard creates the perfect outdoor oasis. Two street frontages complete this extremely versatile offering by allowing for excellent covered carport off street parking.

2 1 1

Auction Saturday 1st December at 1.30pm

**Nicholas Hoo**  
0435 728 272

**Oliver Bruce**  
0409 856 599

**Evelyne Ioannou**  
0425 700 938

  
**MARSHALLWHITE**

101 Dundas Place, Albert Park

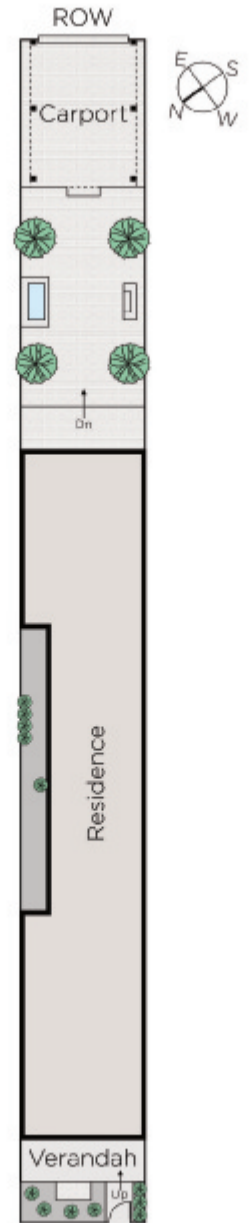
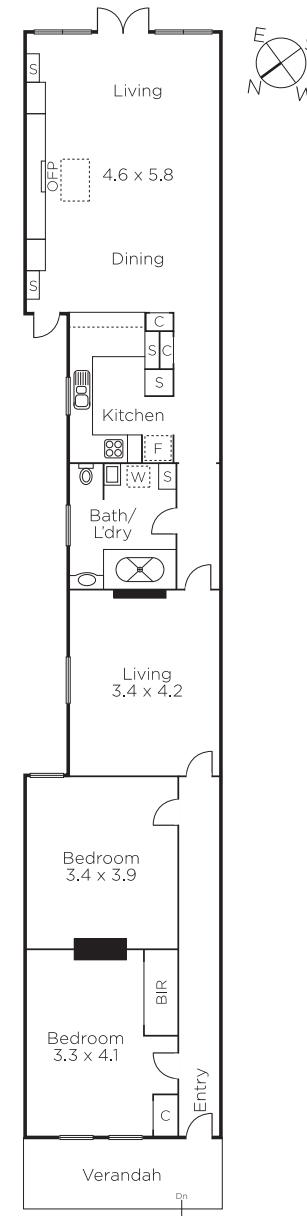

Disclaimer: Information provided is believed to be accurate as at the date of printing, no responsibility is taken for any errors or omissions. It is your responsibility to obtain independent, professional advice. Personal information collected from you is for security purposes and to contact you should the property sell prior to auction. We may use this information to provide you with other real estate services including referrals to authorised financial services providers. Visit our website at [www.marshallwhite.com.au](http://www.marshallwhite.com.au) for our privacy policy.