



MARSHALLWHITE
ONE

67B Lord Street
Richmond



Superior Inner-Suburban Living

As new, this two bedroom designer home brilliantly utilises the space and light whilst presenting a sophisticated home free of the need for maintenance, in one of inner-suburban Melbourne's most desirable locations that is close to everything.

When you're not out enjoying the bars and restaurants of Swan St, Bridge Rd or even the CBD, the home offers open-plan living upstairs with soaring ceilings, Caesar Stone kitchen benches, Blanco appliances and a generous balcony that is perfectly oriented for enjoying the city views. Also features a central bathroom with independent bath and shower as well as separate WC, a second WC/powder room, plus European laundry and reverse cycle air conditioning.

The sports precinct is easily walkable, plus there are concerts, the Yarra River, all transport and the very best of Richmond all at your fingertips.

67bLordstreet-richmond.com



Auction Saturday 24th February at 1.30pm

Luke Saville 0437 720 806

801 Glenferrie Road Hawthorn

Bethany Wilkinson 0449 285 813

9822 9999 mwone.com.au

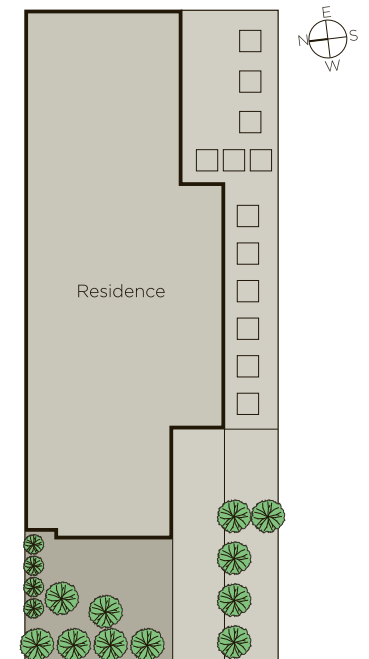
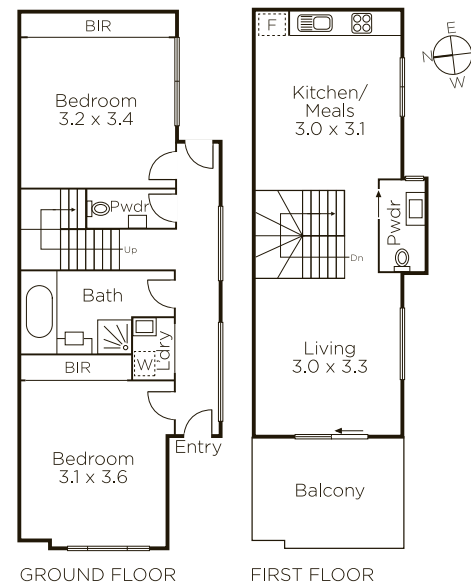

MARSHALLWHITE
ONE

Disclaimer: Information provided is believed to be accurate as at the date of printing, no responsibility is taken for any errors or omissions. It is your responsibility to obtain independent, professional advice. Personal information collected from you is for security purposes to contact you should the property sell prior to auction. We may use this information to provide you with other real estate services including referrals to authorized financial services providers. Visit our website at www.mwone.com.au for our privacy policy.