



6/787

6/787



  
MARSHALLWHITE  
ONE  
6/787 Burwood Road  
Hawthorn East





## Views to the City, Positioned for Lifestyle

Set in a boutique building of only six units, this beautifully presented, bright and well-appointed second-floor apartment of indisputable quality offers stylish living in close proximity to the vibrant Camberwell and Hawthorn areas abundant with shops, cafes, restaurants and importantly the train / tram network.

The open plan kitchen / meals area with beautiful parquet flooring flows into the naturally light filled lounge which provides terrific views stretching out to the CBD skyline. With two generously sized double bedrooms, both with built in robes, a central bright bathroom with ample space for laundry facilities this residence will appeal to both owner-occupiers and investors. Among the many additional features are quality secondary glazing on all windows, fresh carpeting and ceiling fans in the living area and bedrooms. The property comes with highly secure parking space and intercom entry.

6-787burwoodroad-hawthorneast.com 2 1 1

Auction Saturday 29th April at 12.30pm

Jack Moss 0439 378 954

Bethany Wilkinson 0449 285 813

801 Glenferrie Road Hawthorn

9822 9999 mwone.com.au

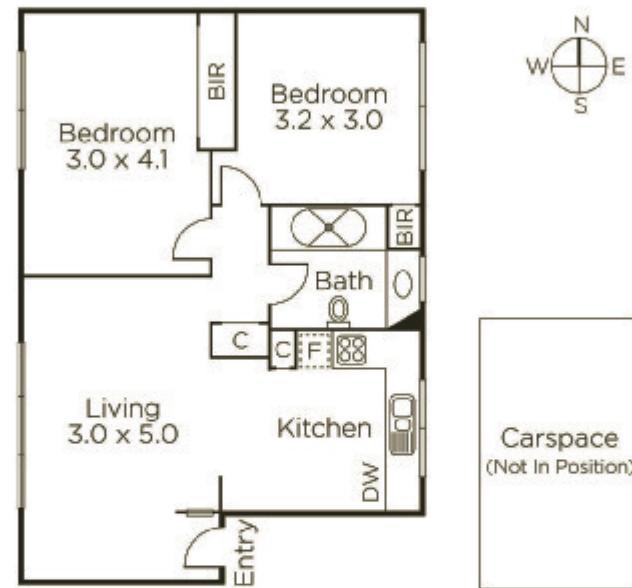

Disclaimer: Information provided is believed to be accurate as at the date of printing, no responsibility is taken for any errors or omissions. It is your responsibility to obtain independent, professional advice. Personal information collected from you is for security purposes to contact you should the property sell prior to auction. We may use this information to provide you with other real estate services including referrals to authorized financial services' providers. Visit our website at [www.mwone.com.au](http://www.mwone.com.au) for our privacy policy.