



MARSHALLWHITE
ONE

609/253 Franklin Street
Melbourne



Highly Secure with a Brilliant Yield

A terrific example of the well-appointed, low maintenance and incredibly efficient inner-city apartment that so many are now craving, this sleek, two bedroom apartment promises an outstanding yield for the astute investor. Directly opposite Queen Victoria Market and just metres from Flagstaff Gardens, this premium location comes with all the benefits of CBD living as well as being within walking distance of Melbourne's most prominent and internationally coveted universities. As it opens to an appealing balcony with authentic, sixth floor, urban views, the kitchen/living is attractive with stone benches and stainless steel appliances, whilst the main bedroom has robes and there is a concealed European laundry. Highly secure with video entry, elevator access and a garbage chute, this home offers everything you or your tenant could possibly need right in the heart of Melbourne.

609-253franklinstreet-melbourne.com 2 1

Private Sale

Jack Nicol 0400 774 428

Joseph Ben-Danan 0408 135 948

1111 High Street Armadale

9822 9999 mwone.com.au

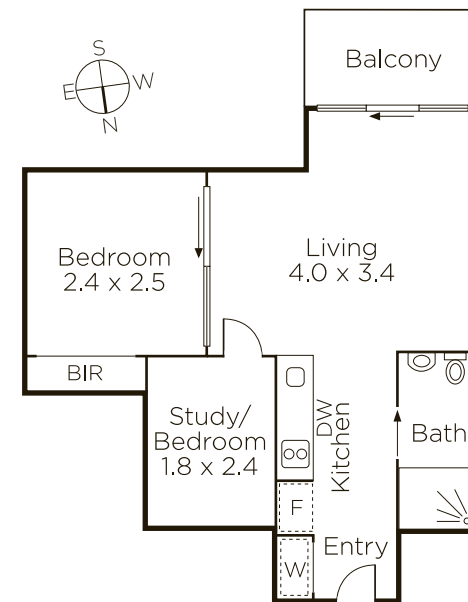

Disclaimer: Information provided is believed to be accurate as at the date of printing, no responsibility is taken for any errors or omissions. It is your responsibility to obtain independent, professional advice. Personal information collected from you is for security purposes to contact you should the property sell prior to auction. We may use this information to provide you with other real estate services including referrals to authorized financial services' providers. Visit our website at www.mwone.com.au for our privacy policy.