



MARSHALLWHITE
ONE

608/1 Porter Street
Hawthorn East



Brand New Sophistication, Junction Lifestyle

The epitome of sleek, economical and sophisticated urban living, right in the thriving heart of Camberwell Junction, this brand new, single bedroom apartment is part of the much-anticipated 'CV One' building. Destined to become a local icon, the emphasis here is on delivering a superior, fully-secure and private, hotel-style level of lifestyle experience, surrounded by shops, eateries, transport and the Tivoli Cinema. Keen to avoid cliché, the home's kitchen is galley-styled with dramatic black soft-close cabinetry, stone bench tops, Miele appliances and an integrated dishwasher, as open-plan living spills out to a north-facing balcony, all while huge floor-to-ceiling windows reveal spectacular views. The bathroom, too, is stone-topped with a European laundry, plus there are large mirrored robes in the bedroom, central heating, cooling, video entry, basement parking, a storage cage and elevator access. Currently let until 30th June 2020 at \$420 per week.

608-1porterstreet-hawthorneast.com 1 1 1

Auction Saturday 30th November at 12.30pm

Samantha Paterson 0417 137 721

801 Glenferrie Road Hawthorn

Danny See 0402 533 853

9822 9999 mwone.com.au

Storage
(Not In Position)

Carspace
(Not In Position)

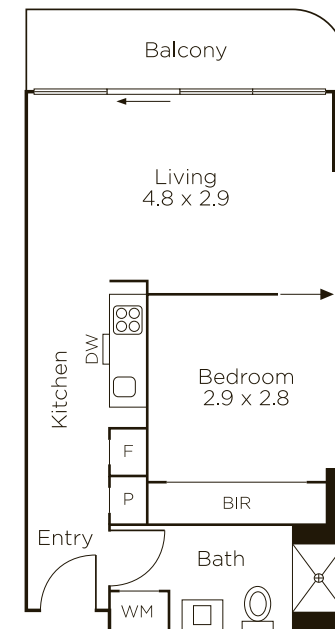

MARSHALLWHITE
ONE

Disclaimer: Information provided is believed to be accurate as at the date of printing, no responsibility is taken for any errors or omissions. It is your responsibility to obtain independent, professional advice. Personal information collected from you is for security purposes to contact you should the property sell prior to auction. We may use this information to provide you with other real estate services including referrals to authorized financial services' providers. Visit our website at www.mwone.com.au for our privacy policy.