



MARSHALLWHITE

6 Glen Drive
Eaglemont

61.72m

35.8m



2100sqm
(approx.)

34.50m

63.36m



Over Half an Acre of Prime Eaglemont Land

Gracing a magnificent land holding of 2,100sqm approx. in a tranquil, garden setting, this spacious, two-storey 5 bedroom contemporary brick residence is highlighted by exceptional zoned family living and entertaining spaces; with a flexible layout and scope for further enhancement if desired. Enviably located in a quiet and peaceful enclave, in one of Eaglemont's finest streets, surrounded by quality real estate.

The refurbished interior features large windows with an abundance of natural light, garden vistas, outlook to pool with expansive outdoor entertaining area. The ground level comprises kitchen, adjoining laundry and pool bathroom, study, rumpus room/retreat, three bedrooms and two further bathrooms with separate WC. A sky lit staircase leads to the upper level featuring vaulted ceilings, a huge formal living and dining room, timber/Euro appointed kitchen, informal living and dining, two further bedrooms, main with WIRs and ensuite; plus a powder room and front and rear verandahs. Other features include intercom, new carpets, drive-in and drive-out circular driveway to 4-car garage with rear cul-de-sac access.

5  3  4 

Auction Saturday 15th September at 12.30pm

Nick Ptak
0413 370 442

Antony Woodley | Collins Simms
0421 286 741

MARSHALLWHITE
801 Glenferrie Road, Hawthorn

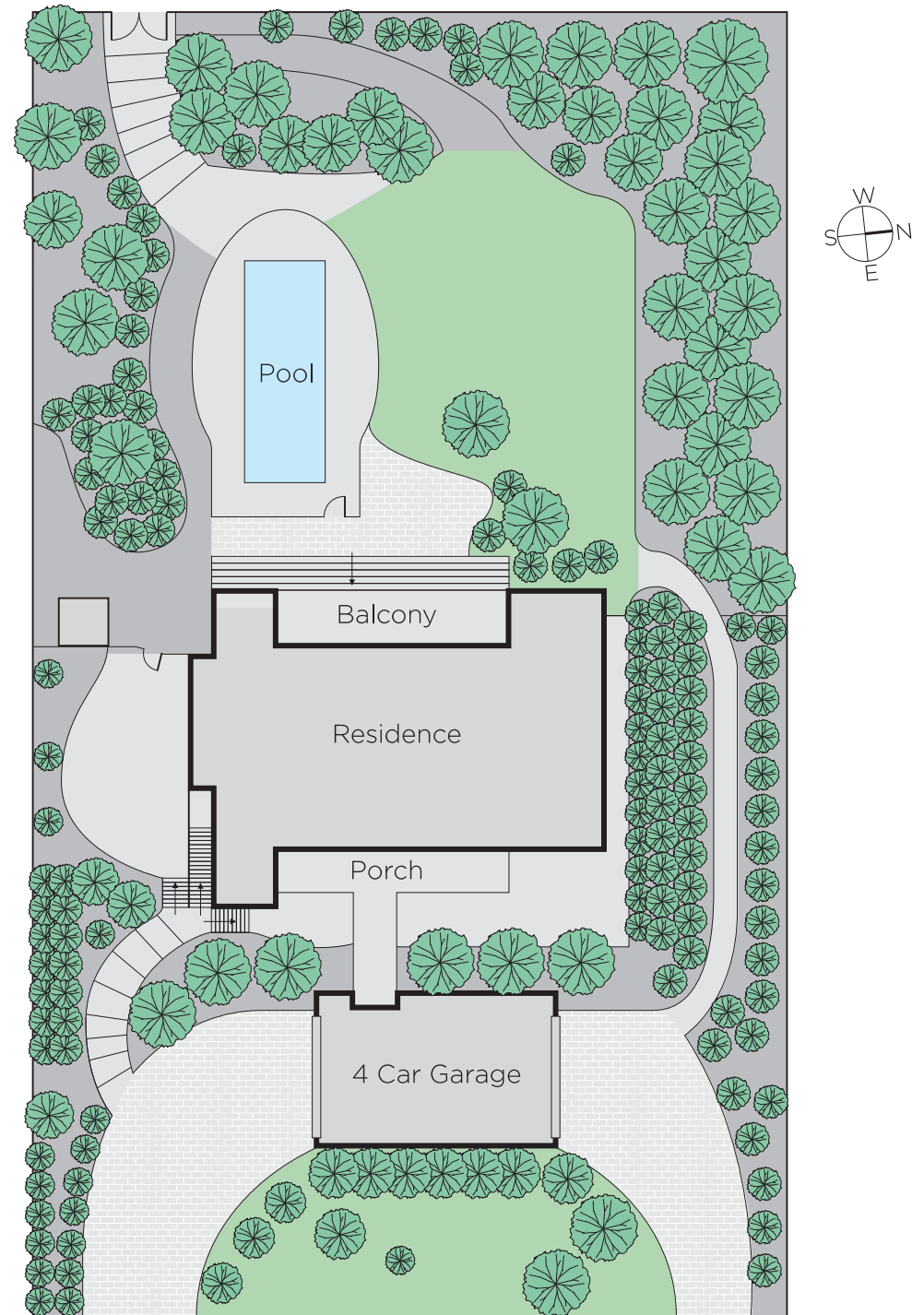

Disclaimer: Information provided is believed to be accurate as at the date of printing, no responsibility is taken for any errors or omissions. It is your responsibility to obtain independent, professional advice. Personal information collected from you is for security purposes and to contact you should the property sell prior to auction. We may use this information to provide you with other real estate services including referrals to authorised financial services' providers. Visit our website at www.marshallwhite.com.au for our privacy policy.