



  
MARSHALLWHITE

6 Durham Road  
Surrey Hills









## Captivating Elegance, Compelling Family Appeal

Impressively combining glorious period elegance with light-filled contemporary style and an address that is brilliantly situated near schools, Chatham station, parks and Maling and Union Rd shops, this captivating 4 bedroom Edwardian family home impeccably caters to every stage of family life. Wonderful proportions, high ornate ceilings and leadlight windows are displayed through the wide entrance hall, beautiful sitting room (open fireplace) and the formal dining room with open fire and north-facing balcony. Year round natural light streams through the generous family/meals area featuring polished timber floors and a stunning renovated gourmet kitchen boasting stone benches and Miele appliances. The living areas open to a large entertaining deck and the deep private northwest garden superbly planted to highlight seasonal colour. The exquisite main bedroom with a gas fireplace and built in robe is complemented by a second double bedroom with ensuite and built in robe, two additional double bedrooms with open fireplaces and built in robes and a central family bathroom. Completely captivating, it also includes plantation shutters, laundry, irrigation, outdoor lighting, garden shed and double carport. Land 861sqm (approx.)

[6durhamroad-surreyhill.com.au](http://6durhamroad-surreyhill.com.au)

4  2  2 

Auction Saturday 22nd July at 12.30pm

Nicholas Franzmann 0412 247 175

Nikki Van Gulick 0419 325 911

801 Glenferrie Road Hawthorn

[marshallwhite.com.au](http://marshallwhite.com.au)



  
MARSHALLWHITE

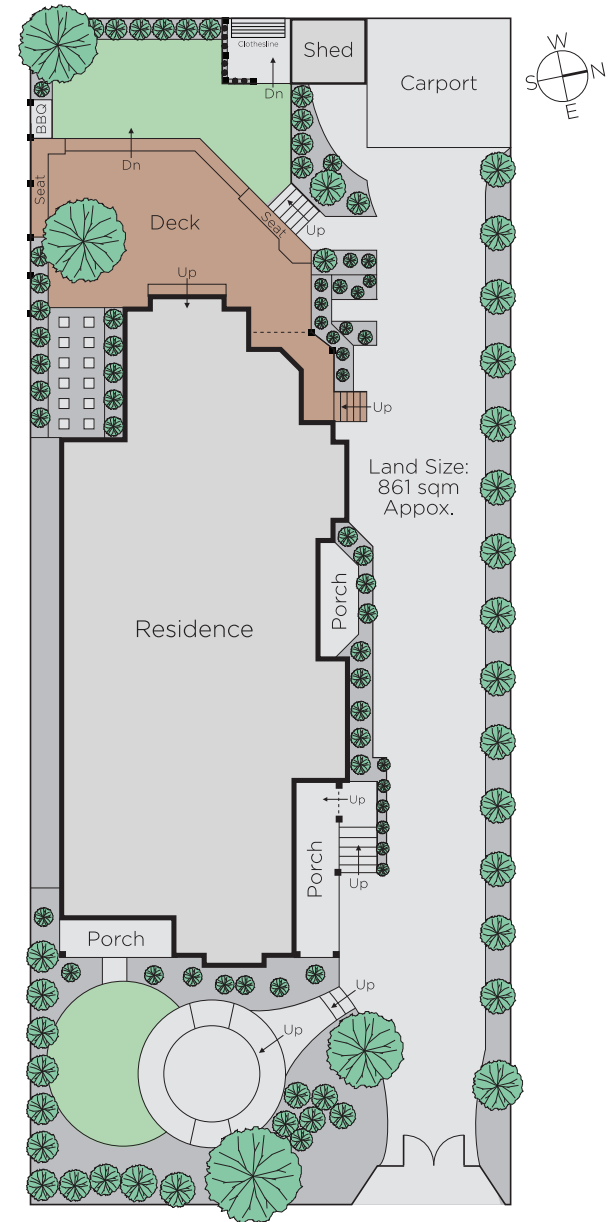
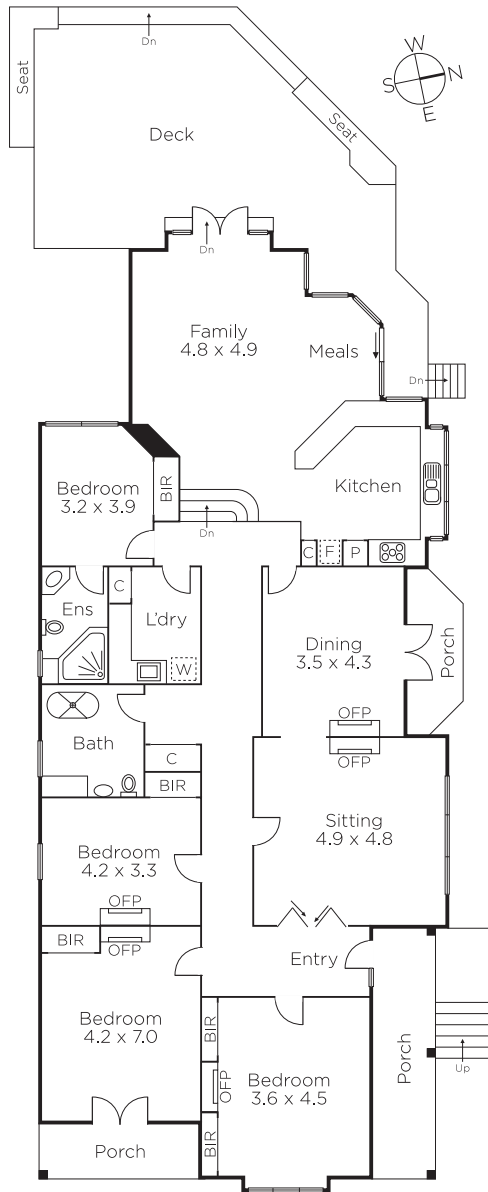

Disclaimer: Information provided is believed to be accurate as at the date of printing, no responsibility is taken for any errors or omissions. It is your responsibility to obtain independent, professional advice. Personal information collected from you is for security purposes and to contact you should the property sell prior to auction. We may use this information to provide you with other real estate services including referrals to authorised financial services' providers. Visit our website at [www.marshallwhite.com.au](http://www.marshallwhite.com.au) for our privacy policy.