



MARSHALLWHITE
ONE

5/10-12 Tennyson Street
Malvern East



Designer Oasis, Just Metres to Waverley Road

This spacious and stylishly renovated, two bedroom townhouse is set amidst a lush and perfectly carved garden setting to create a most exquisitely tranquil sense of sanctuary, just metres from Waverley Rd shops and cafes. Incredibly well-equipped for living areas, the home's rich polished timber floors and lush garden vistas accentuate a crisp white colour palette as the kitchen/meals flows to both a lounge/dining and out to an impressive outdoor entertaining area and beautiful backyard. The garage has been converted to offer additional living - but can easily be reinstated as a garage - while the bedrooms are upstairs with robes and a main bathroom, plus there is a second wc/powder room and a laundry downstairs. Not only are there shops and cafes just around the corner, but there are city bound tram and trains nearby and pretty gardens as well.

5-12tennysonstreet-malverneast.com

2 1 1

Auction Saturday 20th May at 9.30am

Matt Giulieri 0407 851 206

Ross Stryker 0401 318 772

1111 High Street Armadale

9822 9999 mwone.com.au

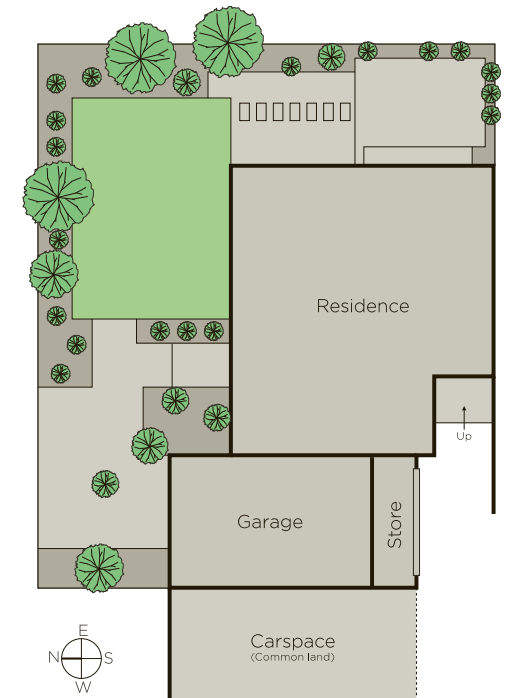

MARSHALLWHITE
ONE

Disclaimer: Information provided is believed to be accurate as at the date of printing, no responsibility is taken for any errors or omissions. It is your responsibility to obtain independent, professional advice. Personal information collected from you is for security purposes to contact you should the property sell prior to auction. We may use this information to provide you with other real estate services including referrals to authorized financial services providers. Visit our website at www.mwone.com.au for our privacy policy.