



51

  
MARSHALLWHITE

51 Haines Street  
Hawthorn





## An Oasis of Charm

A beautifully presented c1910 solid brick Edwardian residence within a delightful historic streetscape which provides an idyllic lifestyle walking distance to Glenferrie Rd shops, restaurants and station, Auburn Village, and a range of schools. Characterised by baltic pine floors and high ceilings with two gorgeous double bedrooms with built in robes, a stylish bathroom, and generous living room with open fireplace. The timber floors extend through an inviting dining area, superbly appointed modern kitchen, and a retreat or study opening to a northeast deck set against a lush, leafy backdrop.

2 1

Auction Saturday 20th October at 10.30am

**Stuart Evans**  
0402 067 710

**Duane Wolowiec**  
0418 567 581

**Luke Saville**  
0437 720 806

  
**MARSHALLWHITE**

801 Glenferrie Road, Hawthorn

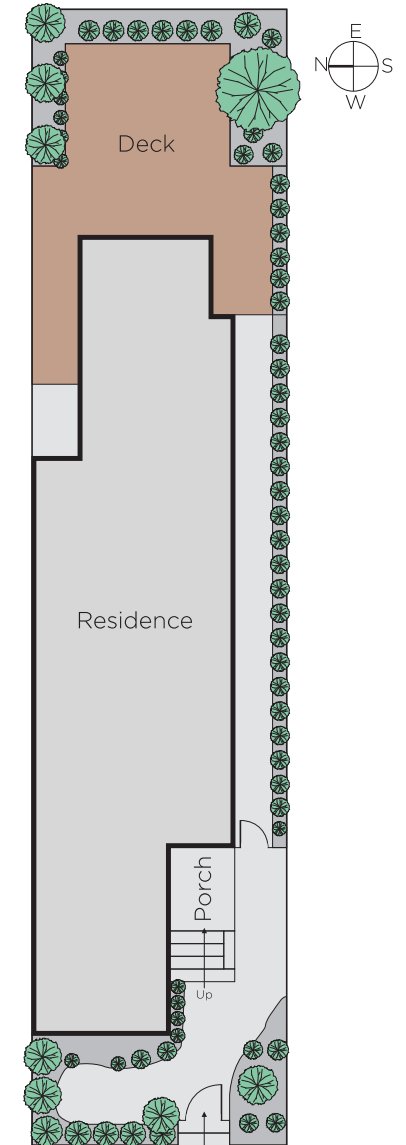
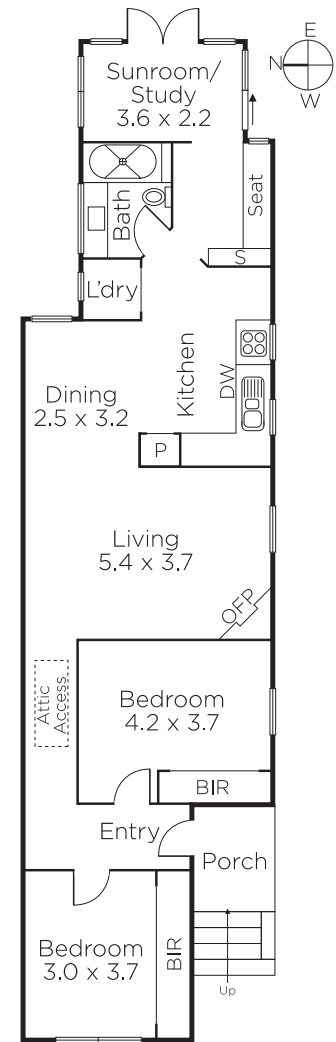

Disclaimer: Information provided is believed to be accurate as at the date of printing, no responsibility is taken for any errors or omissions. It is your responsibility to obtain independent, professional advice. Personal information collected from you is for security purposes and to contact you should the property sell prior to auction. We may use this information to provide you with other real estate services including referrals to authorised financial services providers. Visit our website at [www.marshallwhite.com.au](http://www.marshallwhite.com.au) for our privacy policy.