



MARSHALLWHITE

507 Waverley Road
Malvern East



Corner Land for a Grand Plan

Bring a new era of luxury living to this centrally located address, with the bonus of dual street access and big potential STCA. Located on the corner of Ramona Avenue, there's plenty of scope to make the most of the north-facing land of 699 square metres approx. Three-bedroom home that's stood proudly for more than 50 years is in great shape to live in or rent out while you get plan and permits organised. It's spacious with three living and dining areas, updated kitchen, two bathrooms, and a double garage. Minutes from Chadstone Shopping Centre, and near East Malvern train station and schools.

507waverleyroad-malverneast.com

3 2 2

Auction Saturday 2nd June at 2pm

Hugh Tomlinson
0409 427 483

James Tomlinson
0408 350 684

Alyce Fleming
0499 082 614

MARSHALLWHITE

225 Bay Street, Brighton

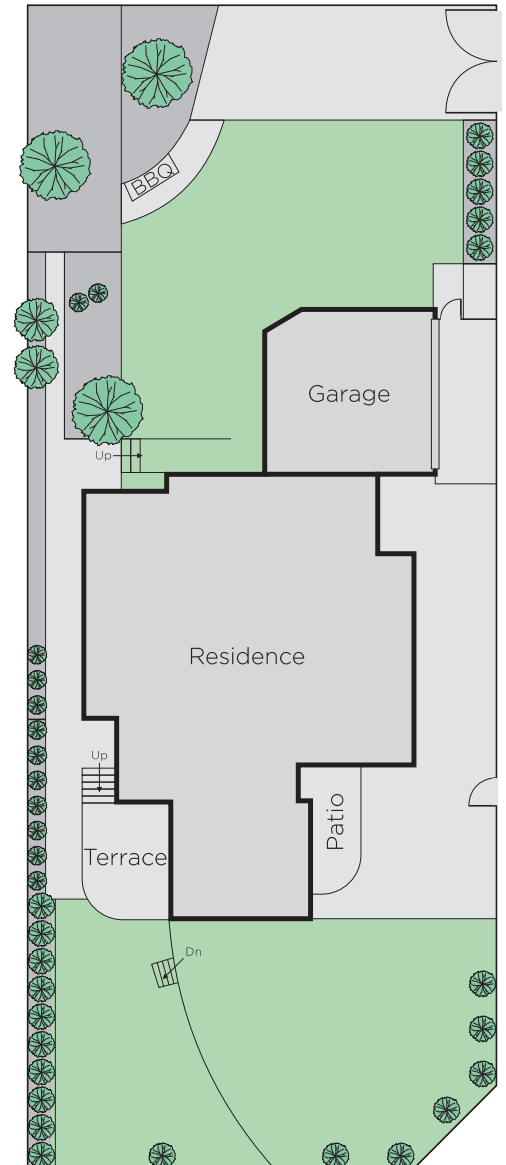
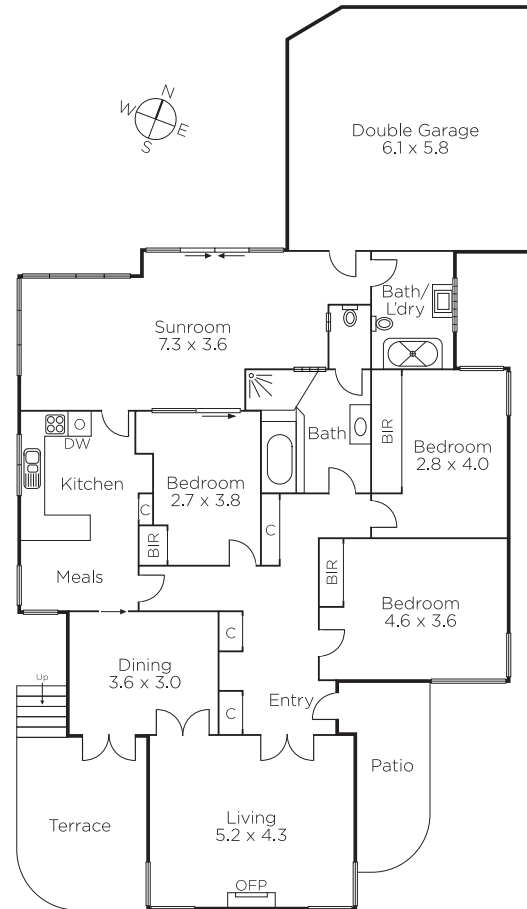

Disclaimer: Information provided is believed to be accurate as at the date of printing, no responsibility is taken for any errors or omissions. It is your responsibility to obtain independent, professional advice. Personal information collected from you is for security purposes and to contact you should the property sell prior to auction. We may use this information to provide you with other real estate services including referrals to authorised financial services providers. Visit our website at www.marshallwhite.com.au for our privacy policy.