

43.63m

7.32m

20.49m



1250sqm  
(approx.)

20.75m

53.43m

  
MARSHALLWHITE

507 Orrong Road  
Armadale









## Prized Location, Premier Opportunity

Superbly occupying a prime 1250sqm (approx.) allotment on the corner of Karbarook Ave and benefiting from a GRZ Schedule 3 zoning, this c1930's English style residence, divided into three separate apartments, represents an outstanding opportunity for a luxury development (STCA). Defined by period charm and generous proportions, the three impeccably presented apartments comprising 5, 3 and 2 bedrooms are currently leased. Enjoying a long north-facing boundary and car access from Orrong Rd and leafy Karbarook Ave, it is enviably situated walking distance to a number of schools, High Street shops, restaurants, Orrong Park and trams to the city. A unique opportunity to capitalize on an exceptionally large northwest facing allotment with 2 street frontages and a coveted tree-lined address in one of Melbourne's most tightly held locations.



[507orrongroad-armadale.com](http://507orrongroad-armadale.com)

10  6  7 

Auction Saturday 5th May at 10.30am

**Dean Gilbert**  
0418 994 939

**Nicholas Franzmann**  
0412 247 175

**James McCormack**  
0410 503 389



  
MARSHALLWHITE

1111 High Street, Armadale

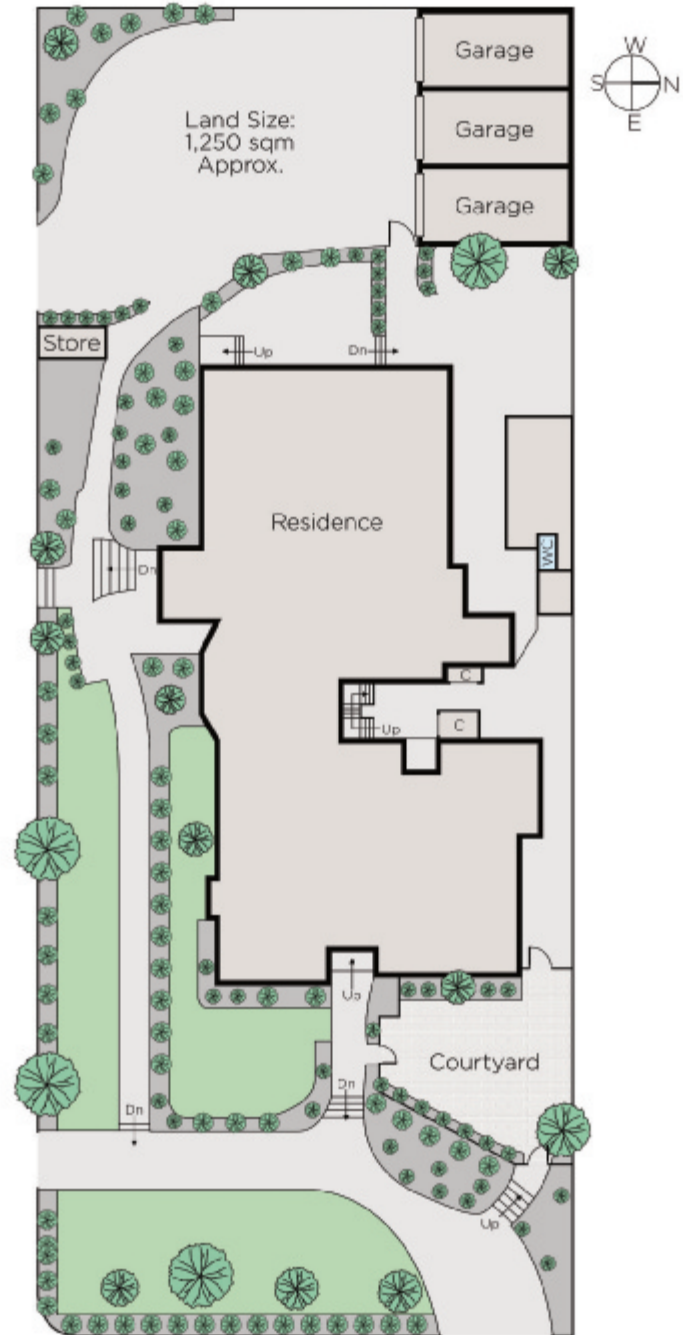

Disclaimer: Information provided is believed to be accurate as at the date of printing, no responsibility is taken for any errors or omissions. It is your responsibility to obtain independent, professional advice. Personal information collected from you is for security purposes and to contact you should the property sell prior to auction. We may use this information to provide you with other real estate services including referrals to authorised financial services' providers. Visit our website at [www.marshallwhite.com.au](http://www.marshallwhite.com.au) for our privacy policy.