



MARSHALLWHITE
ONE

502/20 Camberwell Road
Hawthorn East



LEO - Designer Living in an Unbeatable Position

Style, space and magnificent views are taken to a whole new level in this two-bedroom two-bathroom "LEO" apartment. Carefully considered design ensures its uncompromising living spaces enjoy all day natural light and sweeping Camberwell views, whilst superb interiors by Hecker Guthrie, first class resident amenities and an unbeatable lifestyle position place it in a league of its own. Accessed via a smart lobby and secure lift, clean lines, neutral tones and pale Oak flooring immediately establish a chic Scandinavian feel throughout inviting proportions that include an elegant marble kitchen with Miele appliances and dishwasher, broad undercover balcony, floor to ceiling glazing, extensive built in storage, reverse cycle heating/cooling, video intercom security, storage cage and secure basement parking. A fully equipped resident's gym and garden terrace provide additional space in which to relax, entertain or socialise.

502-20camberwellroad-hawthorneast.com 2 2 1

Private Sale

Luke Saville 0437 720 806
James Hill 0402 421 154

801 Glenferrie Road Hawthorn
9822 9999 mwone.com.au

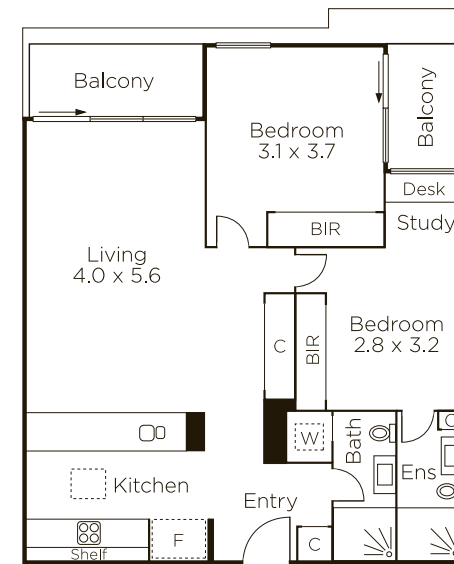

MARSHALLWHITE
ONE

Disclaimer: Information provided is believed to be accurate as at the date of printing, no responsibility is taken for any errors or omissions. It is your responsibility to obtain independent, professional advice. Personal information collected from you is for security purposes to contact you should the property sell prior to auction. We may use this information to provide you with other real estate services including referrals to authorized financial services providers. Visit our website at www.mwone.com.au for our privacy policy.