

PURPOSE: DIVISION 6627/20/R MAP REF: 6627/20/R LAST PLAN:	AREA NAME: MCLAREN VALE COUNCIL: CITY OF ONKAPARINGA DEVELOPMENT NO:	 <h1 style="margin: 0;">D127029</h1> SHEET 1 OF 2 <small>107948_text_01_v05_Version_5</small>	APPROVED: 18/06/2021 DEPOSITED: 03/09/2021
AGENT DETAILS: MICHAEL GREAR SURVEYS 5 GULFVIEW ROAD BLACKWOOD SA 5051 PH: 8278 8732 FAX: 8278 8050 AGENT CODE: MGS7P REFERENCE: 2020216-44B		SURVEYORS I Mark Kenneth Whitford , a licensed surveyor do hereby certify - 1) That this plan has been made from surveys carried out by me and correctly prepared in accordance with the Survey Act 1992. 2) That the field work was completed on the 13th day of April 2021 CERTIFICATION: 18th day of June 2021 Mark Whitford Licensed Surveyor	
SUBJECT TITLE DETAILS:			
PREFIX CT 5206	VOLUME 804	OTHER	PARCEL ALLOTMENT(S)
NUMBER 20	PLAN F	NUMBER HUNDRED / IA / DIVISION 33441	TOWN WILLUNGA
OTHER TITLES AFFECTED:			
EASEMENT DETAILS:			
STATUS EXISTING	LAND BURDENED 43.44	FORM LONG	CATEGORY EASEMENT(S)
IDENTIFIER W	PURPOSE	IN FAVOUR OF THE MINISTER FOR INFRASTRUCTURE	CREATION VM 7533995
ANNOTATIONS: NO OCCUPATION UNLESS OTHERWISE SHOWN LAND ACQUISITION ACT 1969 APPLIES TO THIS PLAN ALLOTMENT 44 IS TO ISSUE IN THE NAME OF THE COMMISSIONER OF HIGHWAYS			

D127029

SHEET 2 OF 2

107948_pland_1_V03_Version_5
BEARING DATUM: MGA 2020 ZONE 54
DERIVATION: GNSS
TOTAL AREA:

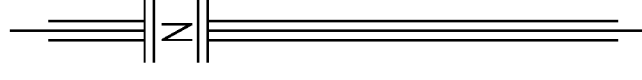

ENLARGEMENT B2
NOT TO SCALE

REFERENCE MARKS				
CNR	BEARING	FROM	DIST.	P.M.No.
1	30°10'	PM FD	1.01	6627/7010
2	350°02'	MP FD	3.76	
2	114°25'	MP FD	1.19	
3	70°37'	MP FD	0.50	
4	-	PM FD	-	6627/7013
5	351°55'	MP FD	0.96	
6	20°34'	MP FD	0.88	
7	38°59'	MP FD	1.01	
8	46°20'	MP FD	1.02	
9	281°45'	MP FD	0.52	
9	281°45'	PM FD	0.99	6627/17918
10	290°55'	PM FD	1.01	6627/7009
11	354°57'30"	MP FD	42.33	

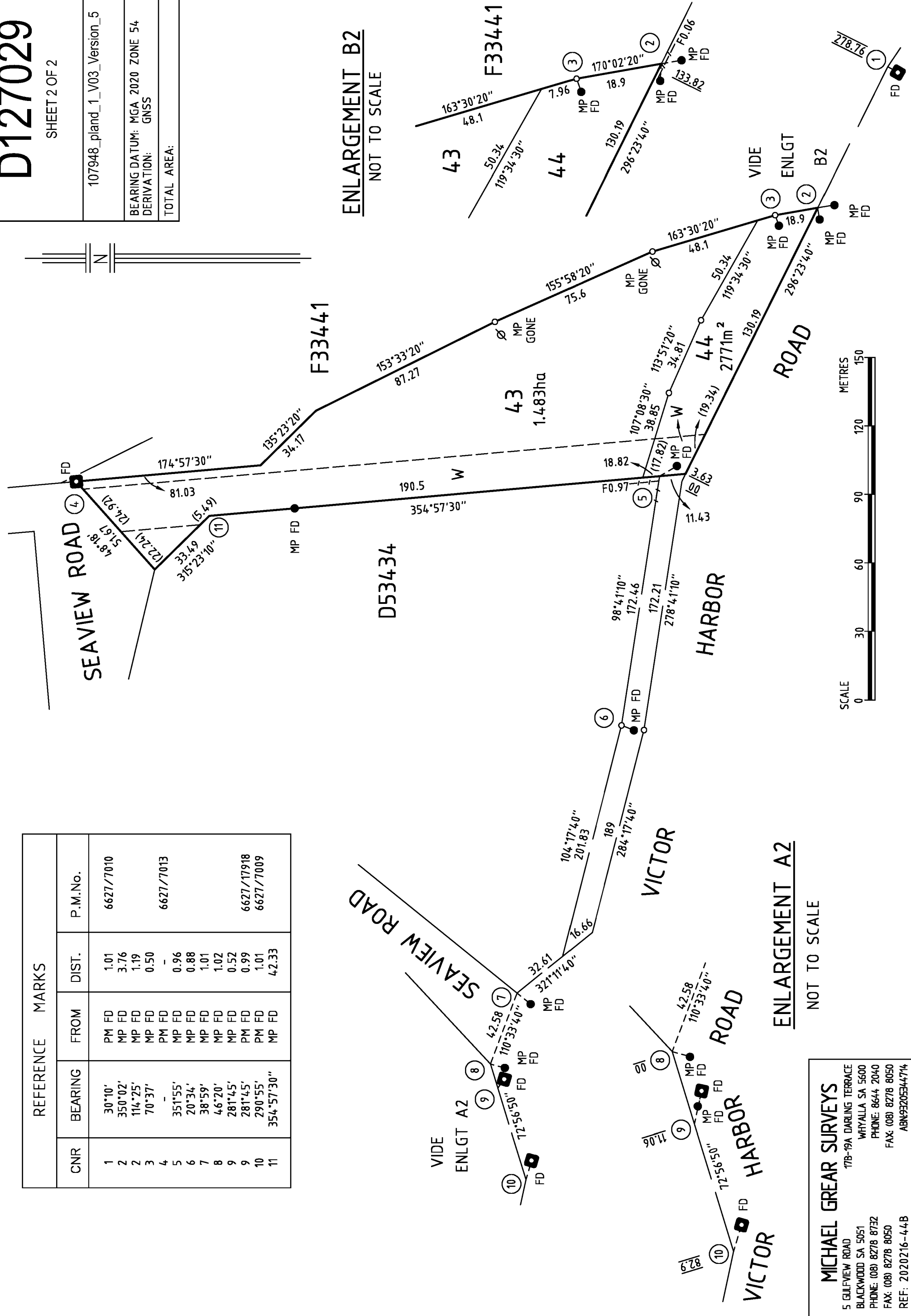

ENLARGEMENT A2
NOT TO SCALE

ENLARGEMENT A2
NOT TO SCALE

MICHAEL GREAR SURVEYS
 178-19A DARLING TERRACE
 WHYALLA SA 5600
 PHONE: (08) 8278 8732
 FAX: (08) 8278 8050
 REF: 2020216-44B
 ABN: 920205344714

5 GULFVIEW ROAD
 BLACKWOOD SA 5051
 PHONE: (08) 8278 8732
 FAX: (08) 8278 8050
 REF: 2020216-44B