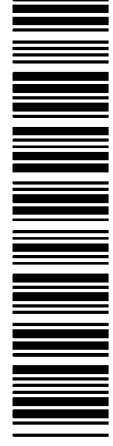

PURPOSE: DIVISION 6627/20/R MAP REF: 6627/20/R LAST PLAN:	AREA NAME: MCLAREN VALE COUNCIL: CITY OF ONKAPARINGA DEVELOPMENT NO:	 D127093 SHEET 1 OF 2 107949_text_01_v04_Version_4	APPROVED: 17/06/2021 DEPOSITED: 03/09/2021
AGENT DETAILS: MICHAEL GREAR SURVEYS 5 GULFVIEW ROAD BLACKWOOD SA 5051 PH: 8278 8732 FAX: 8278 8050 AGENT CODE: MGS7P REFERENCE: 2020216-45A	SURVEYORS I Mark Kenneth Whitford , a licensed surveyor do hereby certify - 1) That this plan has been made from surveys carried out by me and correctly prepared in accordance with the Survey Act 1992. 2) That the field work was completed on the 13th day of April 2021 CERTIFICATION: 16th day of June 2021 Mark Whitford Licensed Surveyor		
SUBJECT TITLE DETAILS: PREFIX 5206 VOLUME 805 OTHER CT PARCEL ALLOTMENT(S)	NUMBER 21 PLAN F NUMBER HUNDRED / IA / DIVISION 33441 TOWN WILLUNGA	REFERENCE NUMBER	
OTHER TITLES AFFECTED:			
EASEMENT DETAILS: STATUS EXISTING LAND BURDENED 45.46	FORM LONG CATEGORY EASEMENT(S)	IDENTIFIER B PURPOSE IN FAVOUR OF DISTRIBUTION LESSOR CORPORATION (SUBJECT TO LEASE 8890000)	CREATION T 3663115
ANNOTATIONS: NO OCCUPATION UNLESS OTHERWISE SHOWN LAND ACQUISITION ACT 1969 APPLIES TO THIS PLAN ALLOTMENT 46 IS TO ISSUE IN THE NAME OF THE COMMISSIONER OF HIGHWAYS			

D127093

SHEET 2 OF 2

107949_pland_1_V02_Version_4

BEARING DATUM: MGA 2020 ZONE 54
DERIVATION: GNSS

TOTAL AREA:

D54378

ENLARGEMENT C2

NOT TO SCALE

REFERENCE MARKS				
CNR	BEARING	FROM	DIST.	P.M.No.
1	30°10'	PM FD	1.01	6627/7010
2	350°02'	MP FD	3.76	
2	114°25'	MP FD	1.19	
3	70°37'	MP FD	0.50	
4	354°56'	PM FD	3.32	6627/7013
5	351°55'	MP FD	0.96	
6	20°34'	MP FD	0.88	
7	38°59'	MP FD	1.01	
8	46°20'	MP FD	1.02	
9	281°45'	MP FD	0.52	
9	281°45'	PM FD	0.99	6627/17918

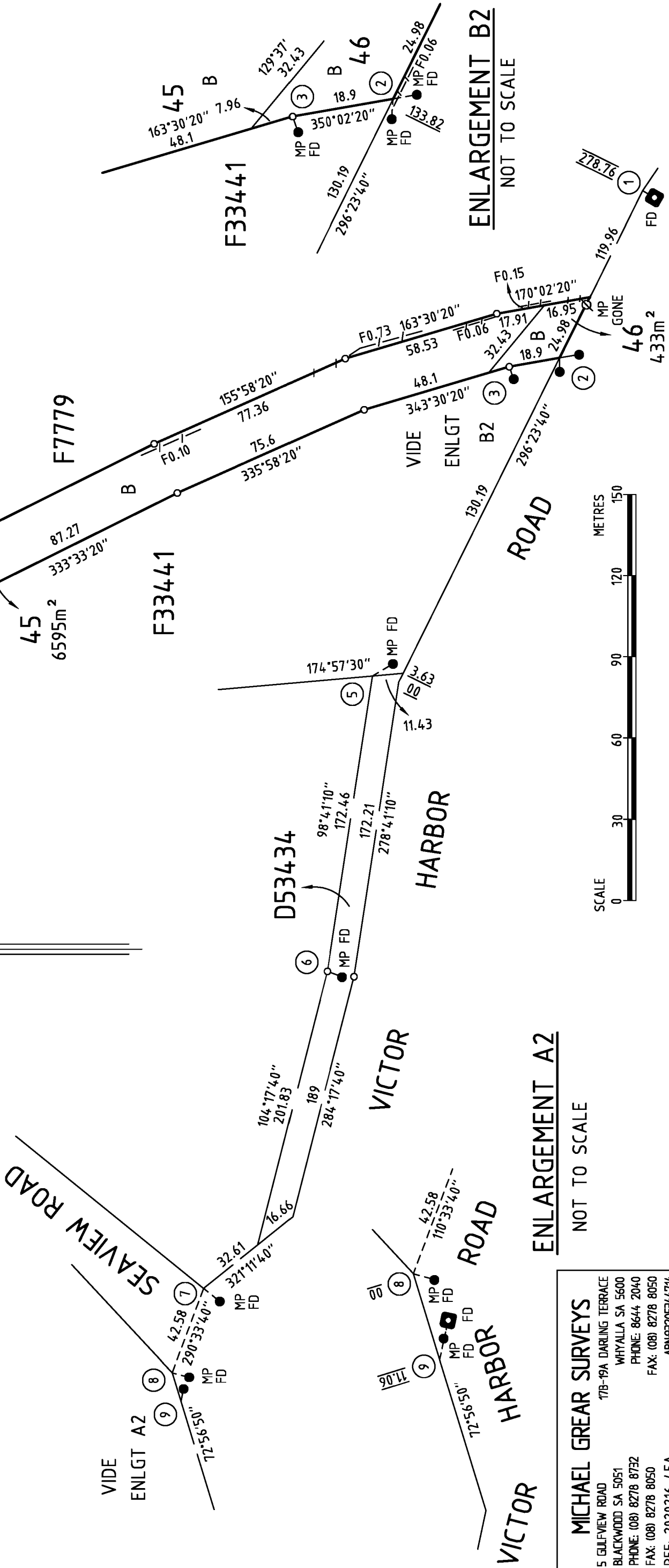

ENLARGEMENT A2

NOT TO SCALE

MICHAEL GREAR SURVEYS
17B-19A DARLING TERRACE
BLACKWOOD SA 5051
PHONE: (08) 8278 8732
FAX: (08) 8278 8050
REF: 2020216-45A