



MARSHALLWHITE

49 Wilgah Street
St Kilda East



Classic Charm, Architectural Style

Displaying a cohesive blend of period charm and contemporary style, this brilliantly renovated period residence provides an inviting, light-filled and superbly zoned family environment near Alma Village, Alma Park, Balaclava Station, trams and schools. Dark timber floors flow through the living room, study, formal dining room and gourmet kitchen. The sensational family room with an open fire and polished concrete floors opens to a private north garden. Three double bedrooms with built in robes are accompanied by two stylish bathrooms. Includes Bose speakers, Euro-laundry, auto gates and off street parking.

49wilgahstreet-stkildaeast.com

3 2 1

Auction Saturday 19th May at 11.30am

Sam Hobbs
0404 164 444

David Volpato
0414 701 983

MARSHALLWHITE

1111 High Street, Armadale

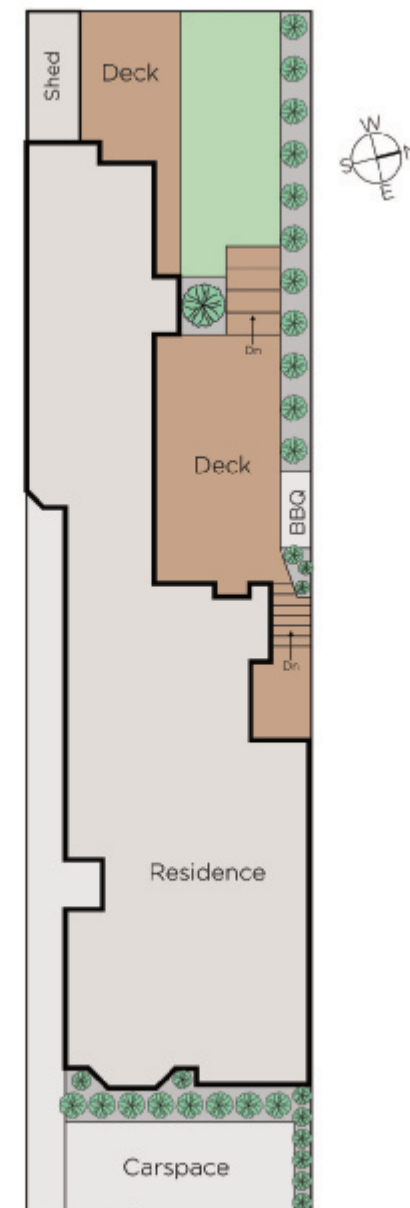

Disclaimer: Information provided is believed to be accurate as at the date of printing, no responsibility is taken for any errors or omissions. It is your responsibility to obtain independent, professional advice. Personal information collected from you is for security purposes and to contact you should the property sell prior to auction. We may use this information to provide you with other real estate services including referrals to authorised financial services providers. Visit our website at www.marshallwhite.com.au for our privacy policy.