



MARSHALLWHITE

4/8 Knutsford Street
Balwyn





Single Level Elegance in Blue Chip Locale

Serenely situated at the rear of a boutique enclave of only 4, this classically elegant single level residence's outstanding proportions provide uncompromised lock up and leave living in a prized location walking distance to Balwyn Village, trams, a range of schools and Balwyn Park. The brilliantly designed and unexpectedly expansive dimensions are bathed throughout in natural light and offer garden outlooks from every aspect. High ceilings accentuate the sense of space in the wide gallery hall and refined formal sitting and dining room with a gas fireplace. The superbly appointed kitchen boasting stone benches and European appliances and a sun-drenched living and dining room open to private north-facing terraces surrounded by lush greenery. The palatial main bedroom with marble en-suite and walk in robe is complemented by a second double bedroom with built in robe, a fitted study or third bedroom and bathroom. Comprehensively appointed with alarm, video intercom, ducted vacuum, laundry, ample storage, auto gates and internally accessed double garage.

3  2  2 

Auction Saturday 20th October at 12.30pm

Stuart Evans
0402 067 710

Duane Wolowiec
0418 567 581

Grayson Rayner
0433 654 744

MARSHALLWHITE
801 Glenferrie Road, Hawthorn

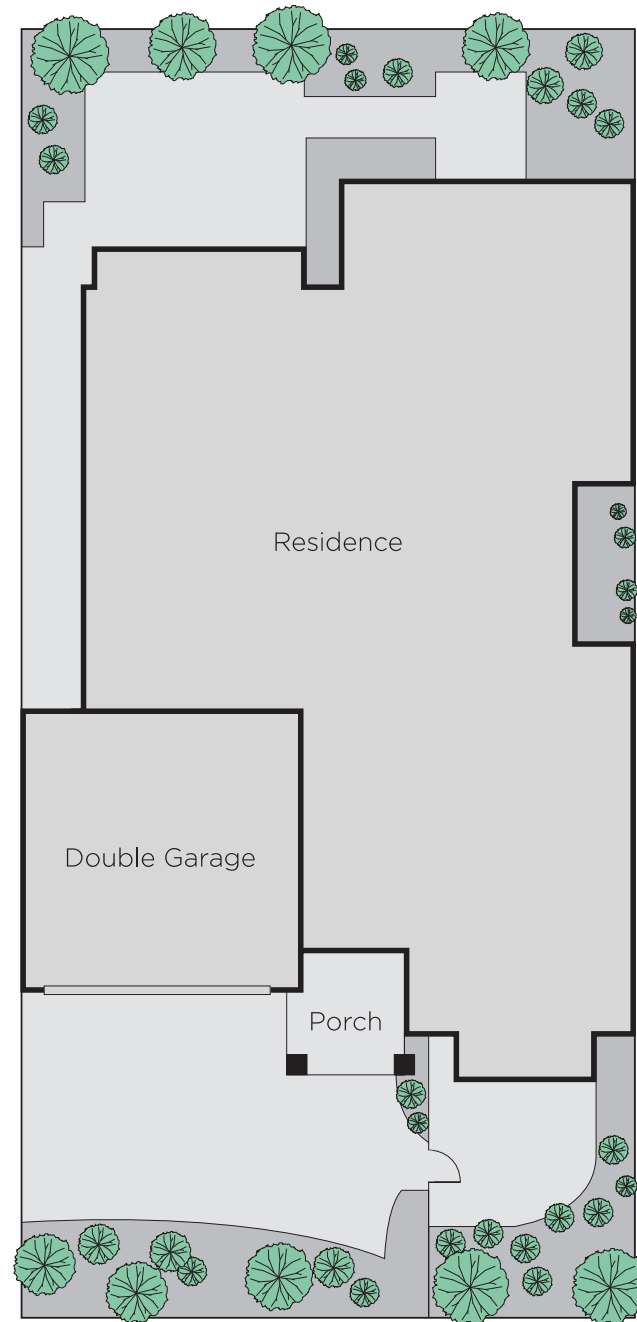
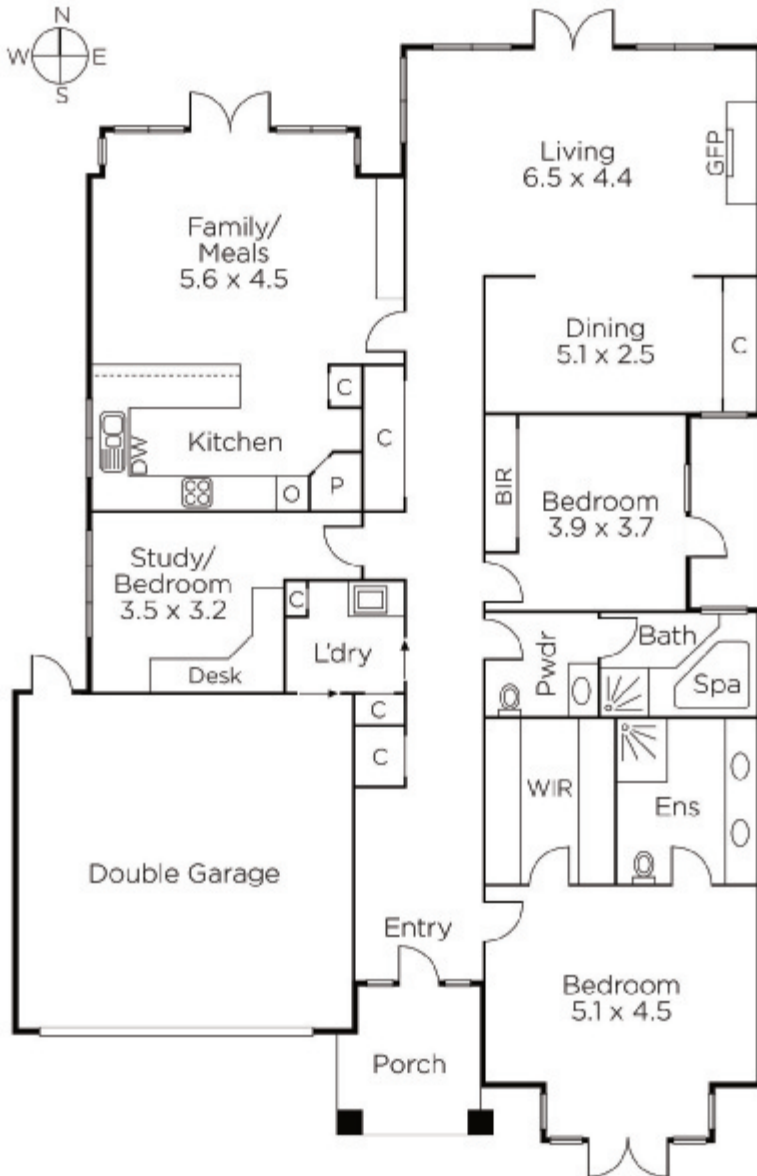

Disclaimer: Information provided is believed to be accurate as at the date of printing, no responsibility is taken for any errors or omissions. It is your responsibility to obtain independent, professional advice. Personal information collected from you is for security purposes and to contact you should the property sell prior to auction. We may use this information to provide you with other real estate services including referrals to authorised financial services' providers. Visit our website at www.marshallwhite.com.au for our privacy policy.