



47



MARSHALLWHITE

47 Pleasant Road
Hawthorn East

47





The Cutting Edge of Contemporary Design

Spectacular in style, luxury and space, this architect designed home sets a new benchmark in relaxed stylish living. Bespoke finishes, lavish proportions, idyllic landscaped garden surrounds and a desirable location within easy reach of both Glenferrie Road, Hawthorn and Camberwell Junction, make this the ultimate, contemporary town residence. Behind a striking, custom-made screen, double height ceilings and honed bluestone floors create a wonderful first impression through the soaring entrance foyer. Spotted Gum floors define the generous open plan living and dining room, with open fireplace and sleek white stone gourmet kitchen boasting Miele appliances, a walk in pantry and garden views through the large windows. Designed for inside and alfresco entertaining, the living area opens onto a tranquil, low-maintenance north-facing garden with covered BBQ terrace. Feature open stairs lead up to the beautiful main bedroom with designer en-suite and walk in robe, two additional double bedrooms with built in robes, a stylish bathroom and bright retreat with elevated views. Land Size: 349sqm approx.

47pleasantroad-hawthorneast.com

3 2.5 2

Auction Saturday 3rd March at 2pm

Anton Zhouk
0430 224 438

Tori McGregor
0400 633 992

MARSHALLWHITE

801 Glenferrie Road, Hawthorn

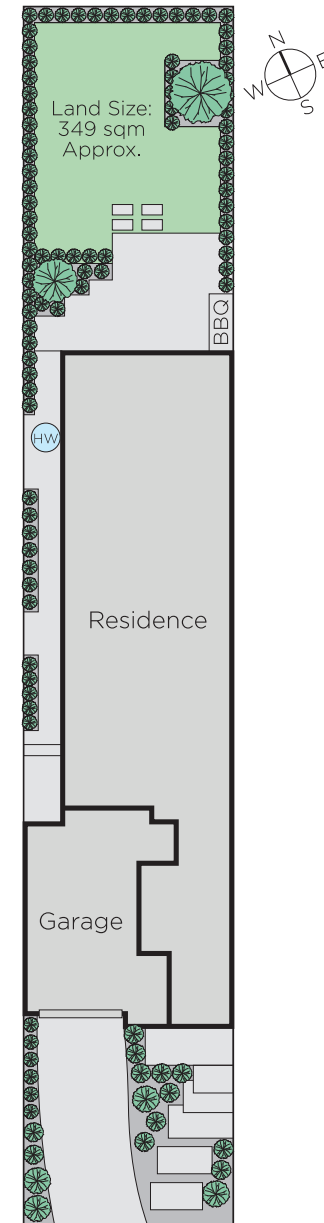
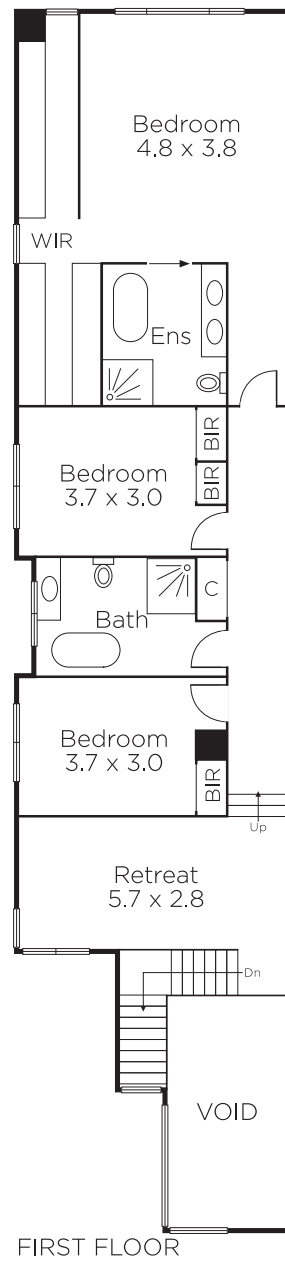
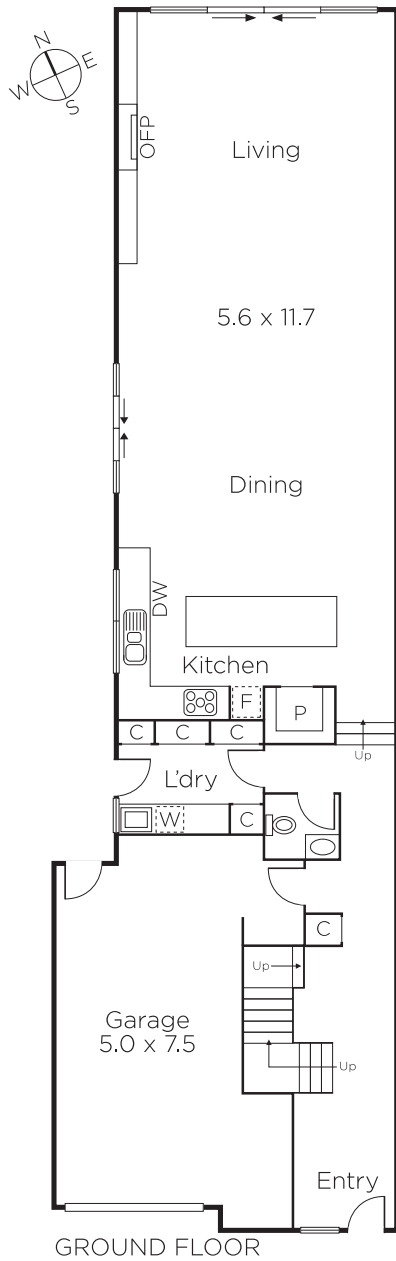

Disclaimer: Information provided is believed to be accurate as at the date of printing, no responsibility is taken for any errors or omissions. It is your responsibility to obtain independent, professional advice. Personal information collected from you is for security purposes and to contact you should the property sell prior to auction. We may use this information to provide you with other real estate services including referrals to authorised financial services' providers. Visit our website at www.marshallwhite.com.au for our privacy policy.