



MARSHALLWHITE

430 Whitehorse Road
Surrey Hills



Inviting Art Deco with Promise

Offering a perfect entry into the Balwyn market this attractive late 1930's Art Deco, solid brick semi-detached home will appeal to young professional couples, retirees or investors. The interior offers scope for further updating/extension if desired (STCA) with retained period attributes, entrance hall, north-facing main bedroom (BIRs), period-style bathroom, living room with gas heater, adjacent dining and kitchen with Asko dishwasher and Smeg stove. Through to a second living room, second bathroom/laundry plus two further bedrooms and a covered alfresco dining area overlooking a deep private garden.

430whitehorseroad-surreyhill.com

3 2 2

Auction Saturday 24th June at 11.30am

Michael Wood 0425 280 191

Jack Stean 0434 588 664

Tori McGregor 0400 633 992

801 Glenferrie Road Hawthorn
marshallwhite.com.au

MARSHALLWHITE

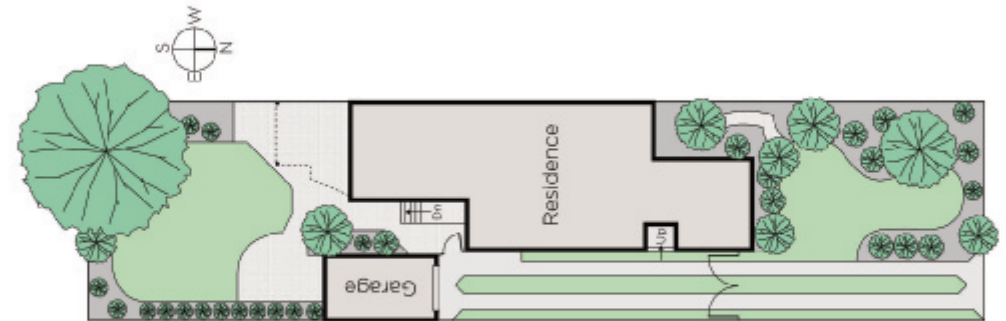
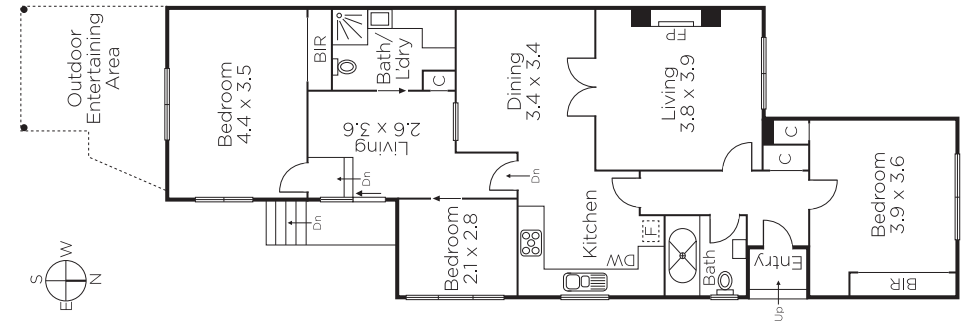

Disclaimer: Information provided is believed to be accurate as at the date of printing, no responsibility is taken for any errors or omissions. It is your responsibility to obtain independent, professional advice. Personal information collected from you is for security purposes and to contact you should the property sell prior to auction. We may use this information to provide you with other real estate services including referrals to authorised financial services' providers. Visit our website at www.marshallwhite.com.au for our privacy policy.