



Chris Barrett

chris.barrett@marshallwhite.com.au
0412 927 409

Andrew Hayne

ah@marshallwhite.com.au
0418 395 349

Peter Mitchell

peter.mitchell@marshallwhite.com.au
0418 374 556

801 Glenferrie Road, Hawthorn



42 Berkeley Street,
Hawthorn



Immaculately presented and ideally located, this spectacular family residence epitomises style and substance, boasting breathtaking city views, heated indoor pool and tennis court. Beyond the private street frontage lies an idyllic 6-bed, 4-bath home over 3 magnificent levels. A stunning entry opens to exquisite formal dining and sitting rooms, open-plan kitchen, living/dining and north-facing terrace. Fully-fitted study, powder room and laundry complete the ground floor with a huge theatre room and wine cellar below. On the top level, the enchanting master bedroom offers private terrace, WIR and spa ensuite. 5 well-proportioned bedrooms and two beautifully-renovated bathrooms provide unparalleled family living, with abundant storage, central heating, air conditioning, CCTV security and double garage. In a prime Scotch Hill location with access to transport, shopping and parklands, this remarkable home must be seen to be believed. Land size 1416sqm approx.

Auction Saturday 3rd March at 3.30pm

42berkeleystreet-hawthorn.com



"A contemporary masterpiece on the crest of Scotch Hill, offering exceptional quality and inspiring design."



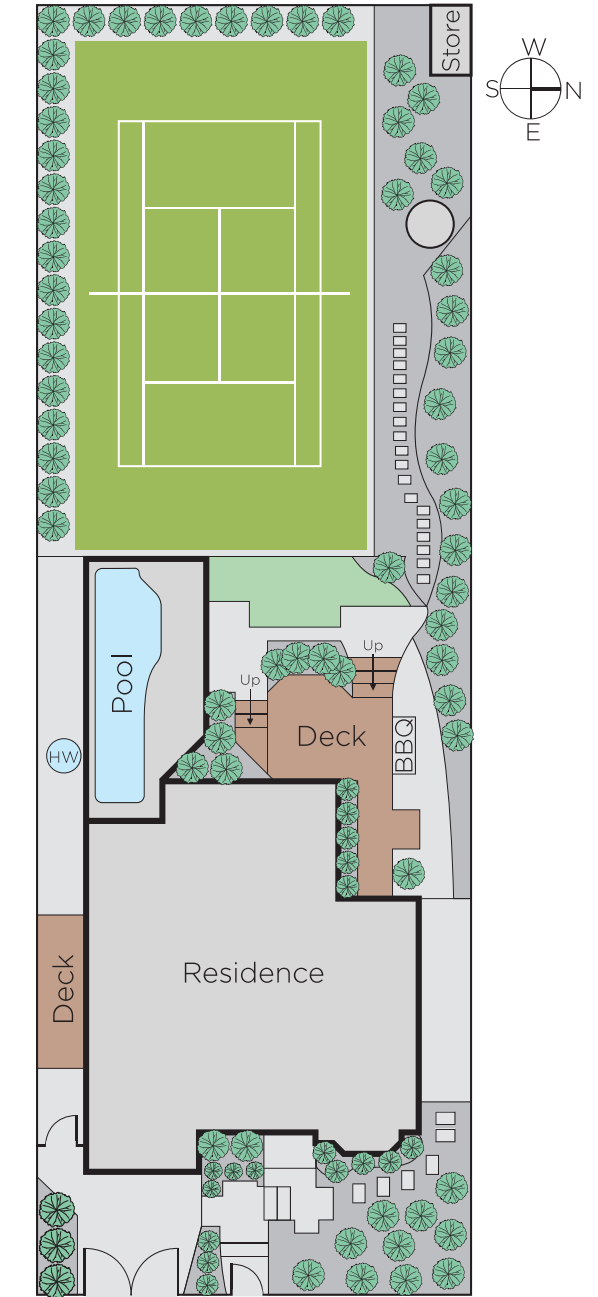
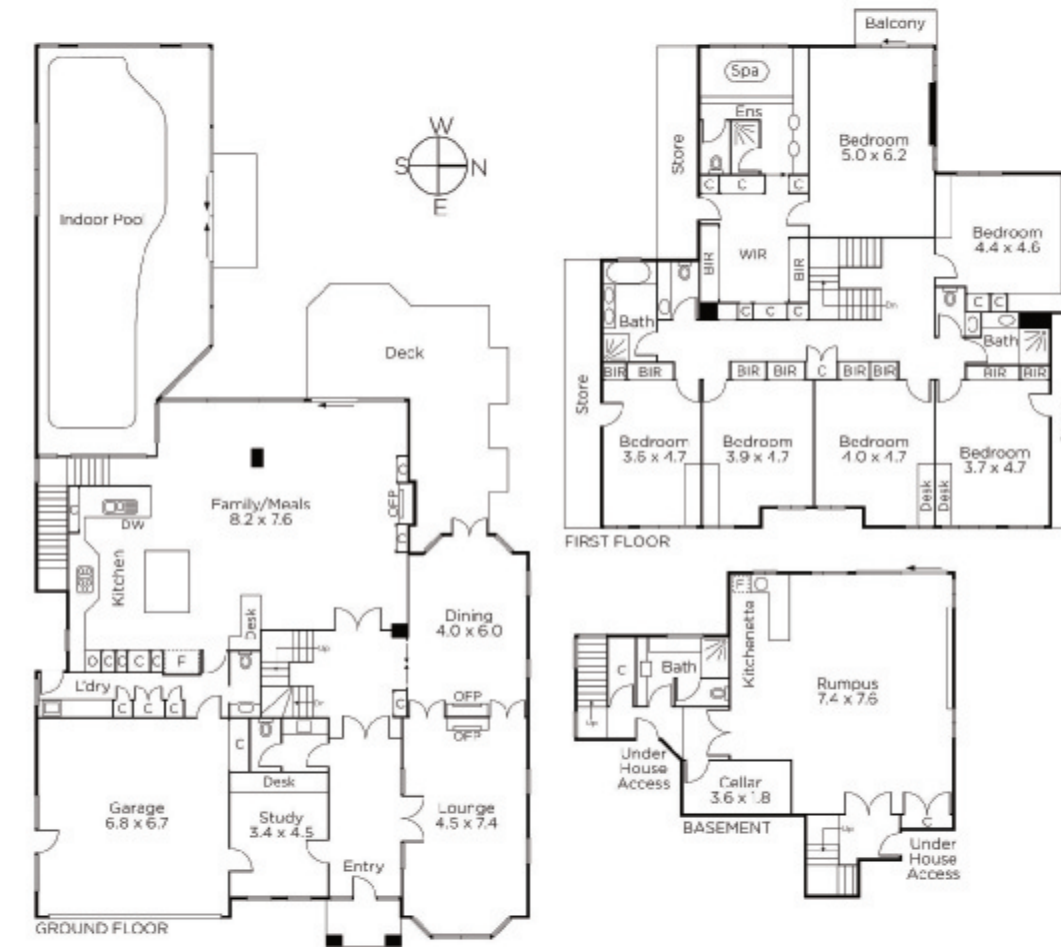

Disclaimer: Information provided is believed to be accurate as at the date of printing, no responsibility is taken for any errors or omissions. It is your responsibility to obtain independent, professional advice. Personal information collected from you is for security purposes and to contact you should the property sell prior to auction. We may use this information to provide you with other real estate services including referrals to authorised financial services' providers. Visit our website at www.marshallwhite.com.au for our privacy policy.