



MARIMA

160

  
MARSHALLWHITE  
ONE

4/160 Chapel Street  
St Kilda



## Art Deco In The Heart of the Action

Surprising size and space lets you spread out and relax in this two bedroom plus study Art Deco apartment whose rich period character and comfortable modern function are perfectly placed to experience all the iconic attractions of Carlisle and Chapel Streets, St Kilda's Botanical Gardens and Elwood's beachside village vibe. One of just six in charismatic MARIMA, generous proportions provide a sun filled top floor haven that's ideal for a busy lock up and leave lifestyle or investment. High ceilings, timber floors and original windows establish the delightful personality of two generous bedrooms and a bright living dining room featuring a fireplace and elevated views. Across the hall, a fully equipped kitchen with meals, bathroom and private study provide immediate comfort whilst also presenting options to update and add value if ever desired. Laundry taps, secure intercom entry and a lock up garage add further convenience.

4-160chapelstreet-stkilda.com

2 1 1

Auction Saturday 24th February at 2.30pm

Joseph Ben-Danan 0408 135 948

1111 High Street Armadale

Bradley Steinbach 0403 539 038

9822 9999 mwone.com.au

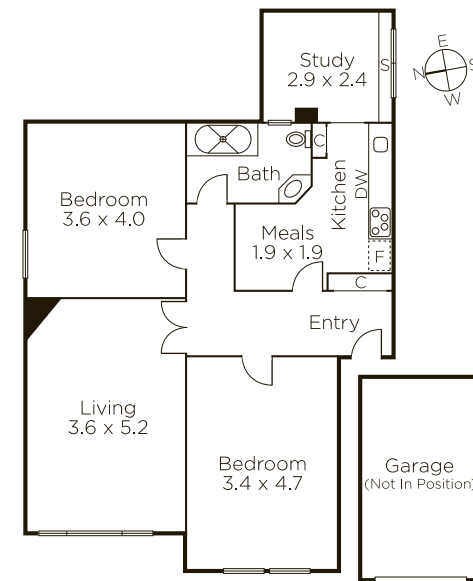

  
MARSHALLWHITE  
ONE

Disclaimer: Information provided is believed to be accurate as at the date of printing, no responsibility is taken for any errors or omissions. It is your responsibility to obtain independent, professional advice. Personal information collected from you is for security purposes to contact you should the property sell prior to auction. We may use this information to provide you with other real estate services including referrals to authorized financial services providers. Visit our website at [www.mwone.com.au](http://www.mwone.com.au) for our privacy policy.