



MARSHALLWHITE
ONE

4/151 Burwood Road
Hawthorn



Urban Sophistication with Vast Outdoor Living

Larger than most single bedroom apartments and with a particularly impressive 19sqm (approx.) courtyard, this streamlined and sophisticated urban pad is a mere five kilometres from the CBD, with a local lifestyle offering that is without peer. The home's CaesarStone-topped kitchen highlights stainless steel appliances and a minimalist sensibility as open-plan living spills easily outdoors to an over-sized private courtyard where a lush garden delivers a rare sense of sanctuary. Accessed securely by intercom, with basement parking and elevator access, the home also efficiently offers robes in the bedroom, a European laundry in the bathroom and split system heating/cooling. Just a gentle stroll from West Hawthorn Village, you are also within walking distance of all the cosmopolitan eateries of Glenferrie Rd, as well as city-bound trains from either Glenferrie or Hawthorn Railway Stations.

4-151burwoodroad-hawthorn.com



Auction Saturday 19th October at 2.30pm

Ash Sachdev 0402 425 661

Samantha Paterson 0417 137 721

801 Glenferrie Road Hawthorn

9822 9999 mwone.com.au

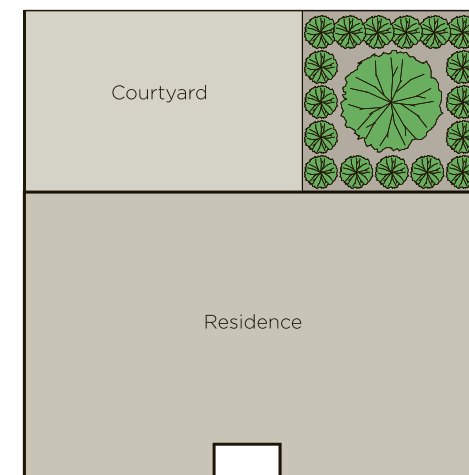
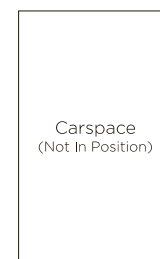
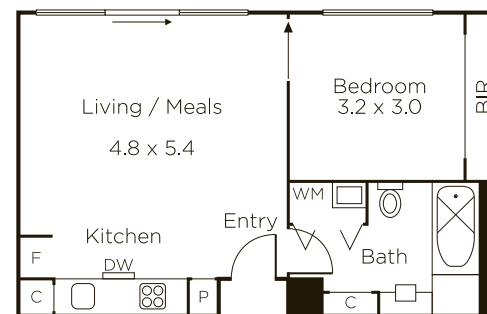

MARSHALLWHITE
ONE

Disclaimer: Information provided is believed to be accurate as at the date of printing, no responsibility is taken for any errors or omissions. It is your responsibility to obtain independent, professional advice. Personal information collected from you is for security purposes to contact you should the property sell prior to auction. We may use this information to provide you with other real estate services including referrals to authorized financial services providers. Visit our website at www.mwone.com.au for our privacy policy.