



MARSHALLWHITE
ONE

4/14 Johnson Street
Richmond



Townhouse Oasis in the Heart of Richmond

Large and spacious dual level townhouse in a tranquil oasis, amazingly quiet and private in the midst of the bustling suburb of Richmond.

This immaculate, as new, two bedroom home with two highly-coveted secure car spaces is wonderfully positioned near Victoria Gardens, Bridge Road and Victoria Street - at the heart of one of Melbourne's most iconic suburbs. A superb low maintenance base for the ultimate inner-city lifestyle, the home is highly secure, quiet and private with vast open-plan living, high apex ceilings and north-facing outdoor area, perfect for entertaining. Also features a private courtyard, two large bedrooms, both with robes (main with WIR/study), ample storage, designer style entertainers kitchen and an exceptionally spacious central bathroom. Heating and cooling throughout, secure intercom entry and roller door entry via lane.

4-14johnsonstreet-richmond.com

Auction Saturday 21st October at 11.30am

Luke Saville 0437 720 806

James Hill 0402 421 154

801 Glenferrie Road Hawthorn

9822 9999 mwone.com.au

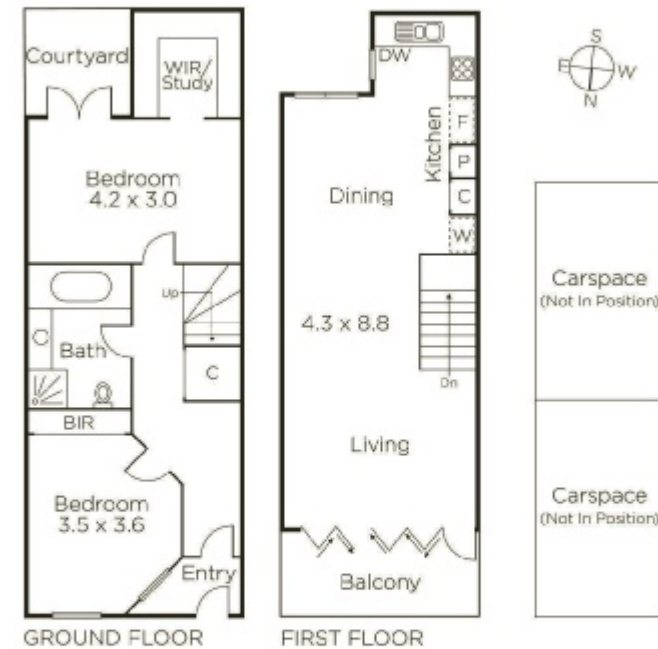

MARSHALLWHITE
ONE

Disclaimer: Information provided is believed to be accurate as at the date of printing, no responsibility is taken for any errors or omissions. It is your responsibility to obtain independent, professional advice. Personal information collected from you is for security purposes to contact you should the property sell prior to auction. We may use this information to provide you with other real estate services including referrals to authorized financial services providers. Visit our website at www.mwone.com.au for our privacy policy.