



MARSHALLWHITE
ONE

401/1 Kennedy Avenue
Richmond



Sophisticated GTV9 with Northern Views

Reflecting the site's iconic status, the GTV9 apartments have become synonymous with inner city style and sophistication. Luxuriously finished and built to the highest of standards, they offer a degree of amenity ideal for those with high expectations seeking a first home, investment or secure CBD base that provides easy access to all the excitement of Richmond and the CBD.

At the end of the hall on the fourth floor, this two bedroom two bathroom apartment showcases its ideal proportions against a backdrop of magnificent northern views that stretch from Richmond to Kew. Two double bedrooms and a stylish bathroom, the main with ensuite, accompany impressive open plan living zones, a designer kitchen featuring Smeg appliances and stone benchtops and deep undercover terrace. Wide board timber floors, heating/cooling, intercom security and basement parking add to the appeal.

401-1kennedyavenue-richmond.com

2 2 1

Auction Saturday 24th March at 9.30am

Luke Saville 0437 720 806

Matthew Grima 0403 438 601

801 Glenferrie Road Hawthorn

9822 9999 mwone.com.au

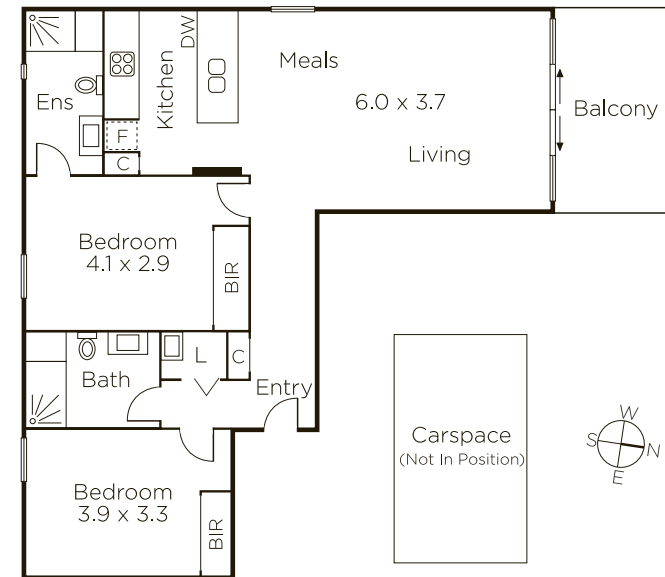

MARSHALLWHITE
ONE

Disclaimer: Information provided is believed to be accurate as at the date of printing, no responsibility is taken for any errors or omissions. It is your responsibility to obtain independent, professional advice. Personal information collected from you is for security purposes to contact you should the property sell prior to auction. We may use this information to provide you with other real estate services including referrals to authorized financial services providers. Visit our website at www.mwone.com.au for our privacy policy.