

ELWOOD BEACH

ELWOOD VILLAGE

ELSTERNWICK PARK



  
MARSHALLWHITE

4 Horton Close  
Brighton





## Park Views from a Mid-Century Modernist Oasis

Views across Elsternwick Park, a courtside address near the beach, and land of 652 square metres approx. offer a rare blend of position and potential. Architect-designed five-bedroom home is in great shape, full of 1960s flair and leafy views from the main living zone and kitchen. Imagine having hectares of open space on your boundary, being able to walk to Elwood's cafes in minutes, and starting the day with a walk along the foreshore. Split-level zoning, privacy, original features, and pristine condition. Make it yours and take it to the next level STCA for exclusive living in the Elsternwick Primary School zone.

5 2 2

Auction Saturday 22nd September at 10.30am

**Andrew Campbell**  
0419 366 545

**Kate Strickland**  
0400 125 946

**Ben Vieth**  
0404 084 793

  
**MARSHALLWHITE**

225 Bay Street, Brighton

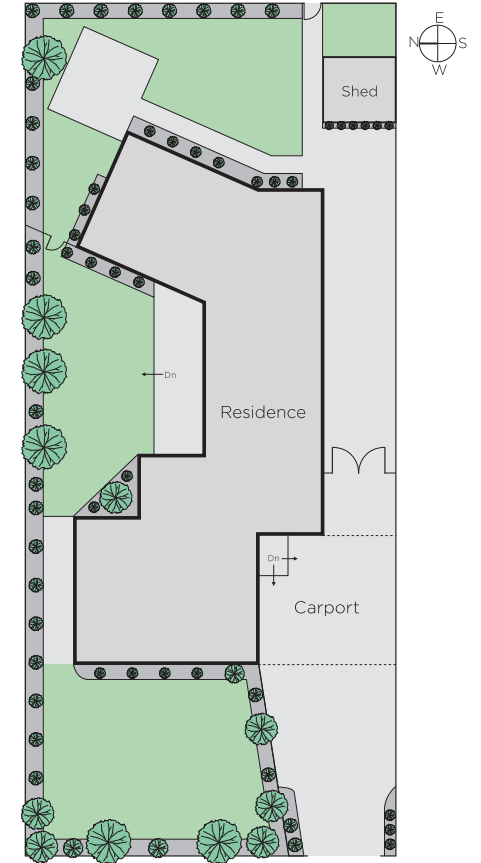
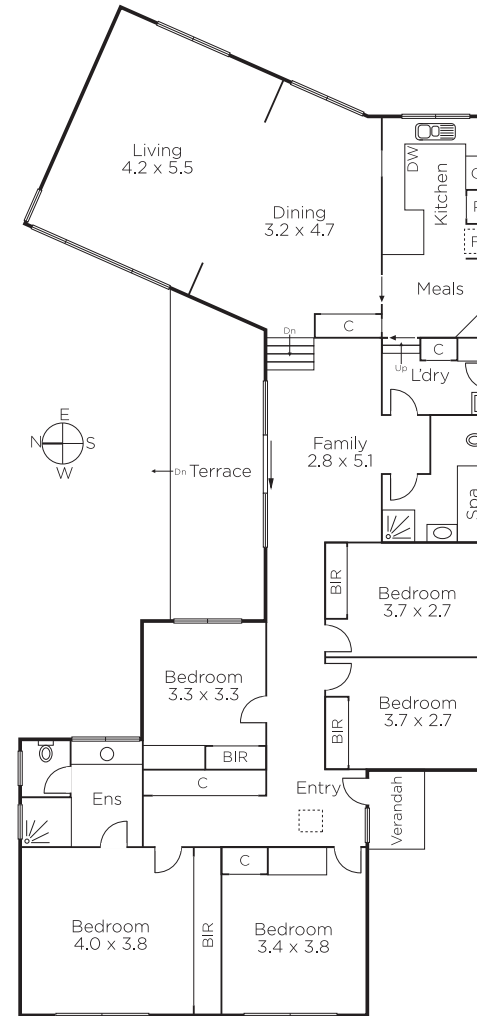

Disclaimer: Information provided is believed to be accurate as at the date of printing, no responsibility is taken for any errors or omissions. It is your responsibility to obtain independent, professional advice. Personal information collected from you is for security purposes and to contact you should the property sell prior to auction. We may use this information to provide you with other real estate services including referrals to authorised financial services providers. Visit our website at [www.marshallwhite.com.au](http://www.marshallwhite.com.au) for our privacy policy.