



MARSHALLWHITE

39 Reed Street
Albert Park



Stunning Bayside Sanctuary

The irresistible appeal of this exquisite Victorian residence's block-fronted façade is matched by its stunning blend of period charm and light-filled contemporary style. Perfectly situated just a short stroll to the beach, Albert Park College and Victoria Ave and trams. Dark Baltic pine floors and high ceilings define the arched hallway and two double bedrooms with robes and a stylish bathroom. Northern light streams through the generous living/dining room and modern kitchen opening to a private north courtyard with workshop appointed with toilet and basin. Rear access via Reed Lane.

39reedstreet-albertpark.com

2 1

Auction Saturday 28th April at 11.30am

Nicholas Hoo
0435 728 272

Evelyne Ioannou
0425 700 938

Laurence Murphy
0421 829 028

MARSHALLWHITE

101 Dundas Place, Albert Park

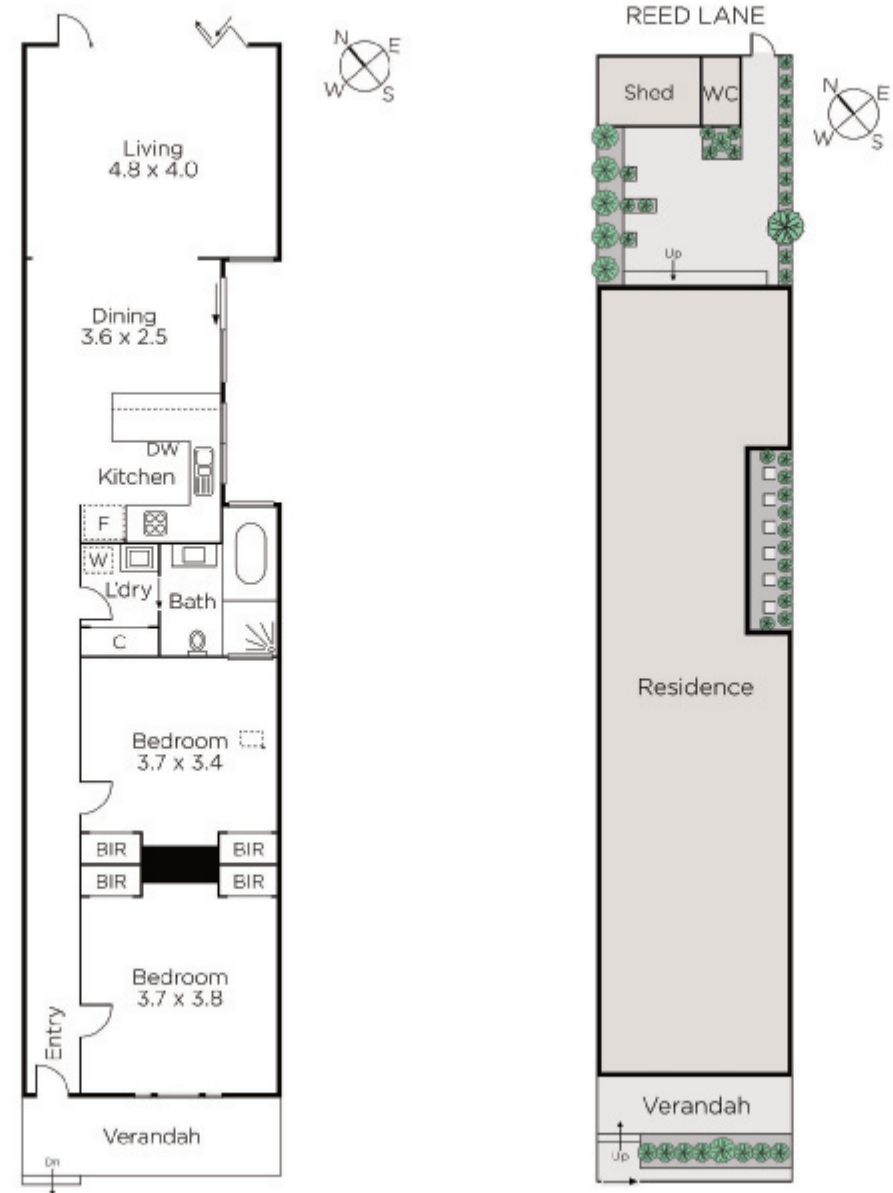

Disclaimer: Information provided is believed to be accurate as at the date of printing, no responsibility is taken for any errors or omissions. It is your responsibility to obtain independent, professional advice. Personal information collected from you is for security purposes and to contact you should the property sell prior to auction. We may use this information to provide you with other real estate services including referrals to authorised financial services providers. Visit our website at www.marshallwhite.com.au for our privacy policy.