



37

38

MARSHALLWHITE

39 Greig Street
Albert Park





Inspired Style, Ideal Location

Stylishly renovated throughout, this captivating solid brick Victorian residence's impressively proportioned dimensions showcase a stunning blend of period elegance and irresistible designer style. A light-filled lifestyle oasis, it is enviably situated just metres from Albert Park Village, trams, Victoria Ave, the beach, schools, St Vincent Gardens and South Melbourne Market. Baltic pine floors flow through the arched hall to two gorgeous double bedrooms with built in robes and a stylish bathroom. A sensational main bedroom suite serenely set on the level above includes built in robes, a chic bathroom and private sun-deck. An evocative dining room with open fireplace leads through to the state of the art kitchen with Miele appliances and marble and stone benches and an expansive living room beneath a sky-lit vaulted ceiling. Bi-fold doors extend the living area to a private decked garden offering potential off street parking via Durham Street. This delightful home also features plantation shutters, alarm, Euro-laundry and pull down storage.

3  2 

Auction Saturday 8th December at 12.30pm

Nicholas Hoo
0435 728 272

Kaine Lanyon
0411 875 478

Sarah Wood
0408 902 827

MARSHALLWHITE

101 Dundas Place, Albert Park

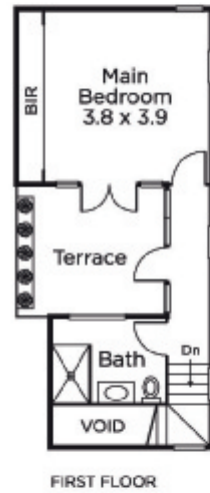
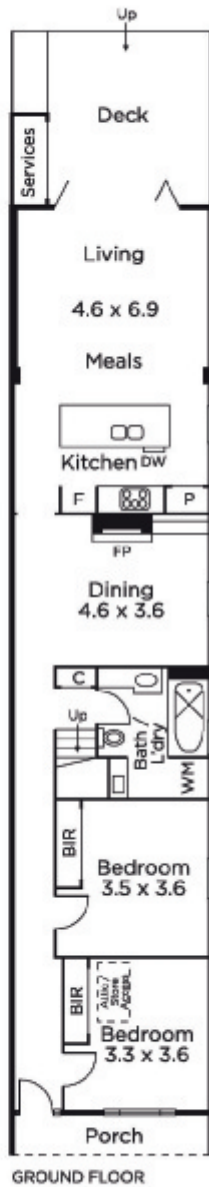

Disclaimer: Information provided is believed to be accurate as at the date of printing, no responsibility is taken for any errors or omissions. It is your responsibility to obtain independent, professional advice. Personal information collected from you is for security purposes and to contact you should the property sell prior to auction. We may use this information to provide you with other real estate services including referrals to authorised financial services' providers. Visit our website at www.marshallwhite.com.au for our privacy policy.