



MARSHALLWHITE

380 Ross Street  
Port Melbourne





## Contemporary Easy-Maintenance Living

Set among the peaceful streets of Port Melbourne, this stylishly renovated town residence delivers the perfect balance of functional family home and entertainer's paradise. Spacious, open-plan living and dining areas flow seamlessly to a well-appointed outdoor entertaining area. The first floor presents main bedroom with ensuite and two additional bedrooms, each with built in robes, as well as a main bathroom. Also includes Euro laundry, powder room, sitting room, double glazed windows, decked front courtyard and off-street parking.

[380crossstreet-portmelbourne.com](http://380crossstreet-portmelbourne.com)

3 2 1

Auction Saturday 17th June at 2.30pm

Oliver Bruce 0409 856 599

Sarah Wood 0408 902 827

Nicholas Hoo 0435 728 272

101 Dundas Place Albert Park  
[marshallwhite.com.au](http://marshallwhite.com.au)

  
**MARSHALLWHITE**

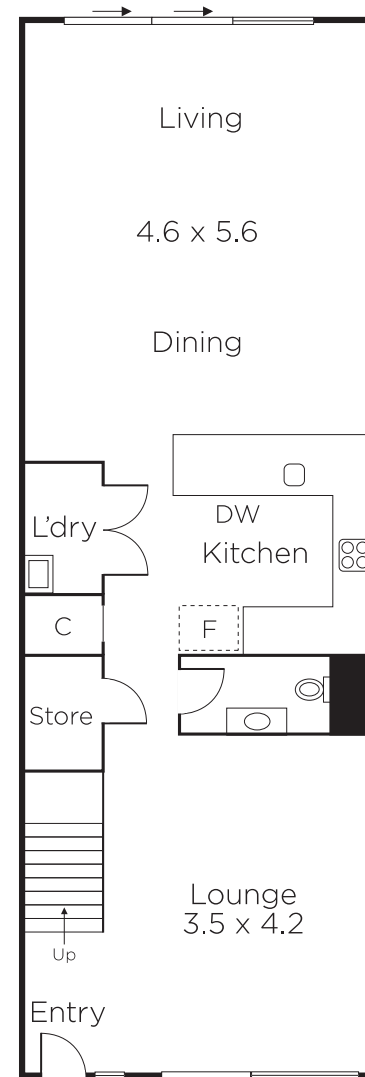

GROUND FLOOR

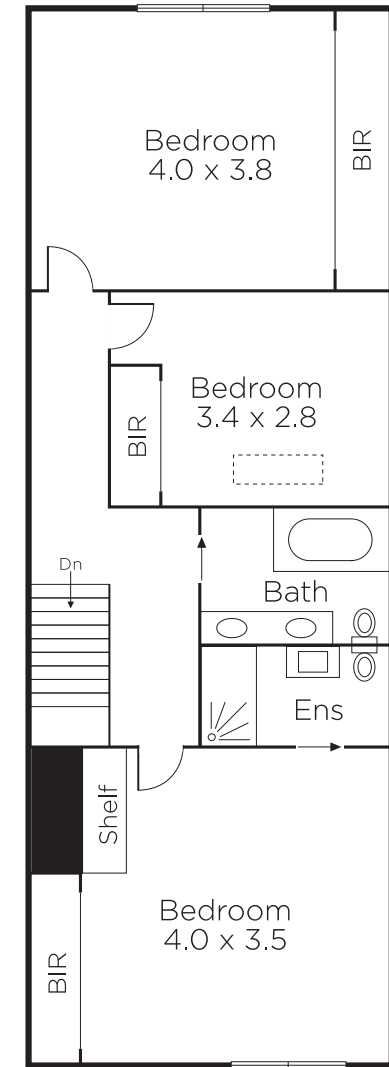

FIRST FLOOR



Disclaimer: Information provided is believed to be accurate as at the date of printing, no responsibility is taken for any errors or omissions. It is your responsibility to obtain independent, professional advice. Personal information collected from you is for security purposes and to contact you should the property sell prior to auction. We may use this information to provide you with other real estate services including referrals to authorised financial services' providers. Visit our website at [www.marshallwhite.com.au](http://www.marshallwhite.com.au) for our privacy policy.