



MARSHALLWHITE

36 Oxley Road
Hawthorn





Victorian Charm, Vibrant Location

Enjoying a premier corner location only moments from Glenferrie Road shops and restaurants, Swinburne University, Glenferrie station, trams and schools. This charming single level Victorian residence offers an outstanding opportunity to enhance its original elegance with an inspired renovation and extension (STCA). Once the home of renowned composer Percy Grainger, its comfortably presented dimensions are perfect to enjoy now while considering the many options. Generous proportions define the entrance hall, light-filled living room, spacious family living and dining room and a well appointed kitchen. The three good sized bedrooms are accompanied by a bright bathroom. On the corner of Camden Road, it also includes a garage, work-shop and store-room.

Land size: 607sqm (approx.)

36oxleyroad-hawthorn.com

3  1  2 

Auction Saturday 27th May at 11.30am

Stuart Evans 0402 067 710

Duane Wolowiec 0418 567 581

Daniel Williams 0402 182 704

801 Glenferrie Road Hawthorn

marshallwhite.com.au

MARSHALLWHITE

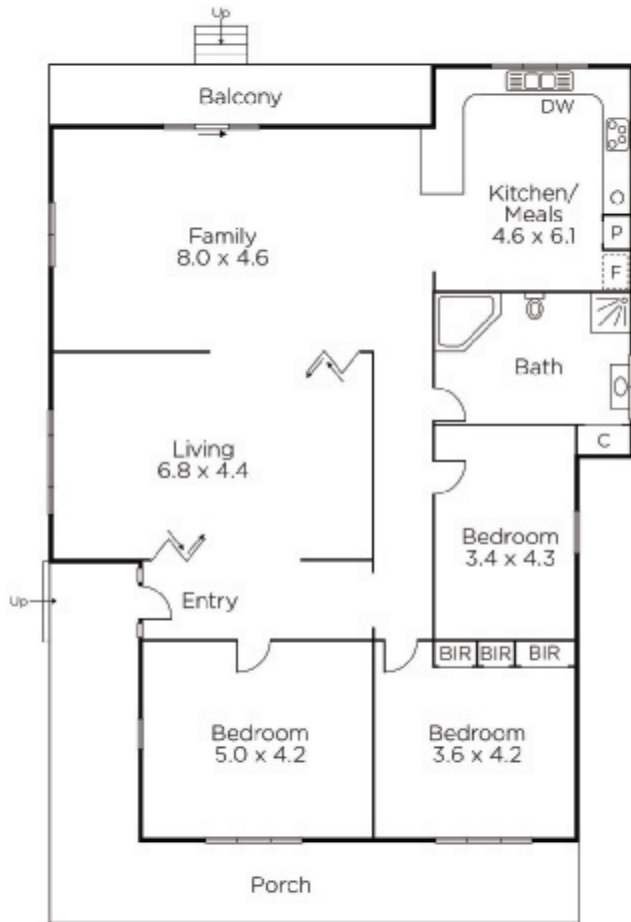

GROUND FLOOR



FIRST FLOOR

