

PARK MANSIONS

546

MARSHALLWHITE
ONE

3/41 Park Street
South Yarra



‘Park Mansions’: Walk to the Botanical Gardens

Perfectly positioned for a sophisticated South Yarra lifestyle, this substantial, light-filled, two bedroom apartment is meticulously presented, just metres from the Botanical Gardens. The home’s lounge/dining enjoys a lovely northern orientation and glimpses of the city skyline as it presents a smart living space that is removed from the kitchen/meals. Each of the bedrooms is generous - one with huge robes and a pretty balcony - whilst the bathroom has laundry facilities and there are gorgeous polished timber floors in the living areas. Also features a lock-up garage, stone kitchen benches and premium kitchen appliances. This blue ribbon city-fringe location delivers you the rare ability to walk to the Botanical Gardens, indulge in some superb local cafes, restaurants and bars, wander down to Toorak Rd for some shopping or jump on the Number 8 tram to the city.

3-4|parkstreet-southyarra.com

2 1 1

Auction Saturday 16th September at 3.30pm

Matt Giulieri 0407 851 206

1111 High Street Armadale

Joseph Ben-Danan 0408 135 948

9822 9999 mwone.com.au

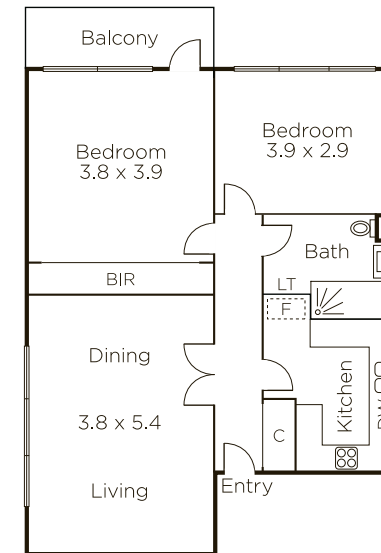

(NOT IN POSITION)



MARSHALLWHITE
ONE

Disclaimer: Information provided is believed to be accurate as at the date of printing, no responsibility is taken for any errors or omissions. It is your responsibility to obtain independent, professional advice. Personal information collected from you is for security purposes to contact you should the property sell prior to auction. We may use this information to provide you with other real estate services including referrals to authorized financial services providers. Visit our website at www.mwone.com.au for our privacy policy.