



MARSHALLWHITE

3/27 Faversham Road
Canterbury





A Stylish, Low Maintenance Canterbury Lifestyle

This luxuriously appointed two-storey contemporary town residence is enviably located in one of Canterbury's coveted tree-lined streets. Setting a bench mark for stylish low maintenance living and clever design, the home is privately positioned in a boutique complex with an interior featuring a neutral décor with engineered French Oak floors, high ceilings and large windows delivering leafy garden vistas. A flowing floorplan includes a powder room plus generous living and dining area incorporating a superb kitchen with CaesarStone bench-tops, island bench and prestige Miele appliances, double integrated fridge/freezer plus an adjoining laundry. All opening to a paved alfresco area in a north-facing courtyard - perfect for indoor/outdoor enjoyment and relaxation. Complemented by four bedrooms, with a choice of upstairs or downstairs main bedroom both with WIRs and fully-tiled ensuites plus an upstairs retreat and family bathroom. Other features include zoned ducted heating & cooling, ducted vacuum, rain water tank and excellent security with video intercom, alarm, remote gates and double garage/storage with direct internal entry and garden access.

4  3  2 

Auction Saturday 24th November at 12noon

James Tostevin
0417 003 333

David Smith
0402 361 680

Scarlett Hang
0405 054 888

MARSHALLWHITE

801 Glenferrie Road, Hawthorn

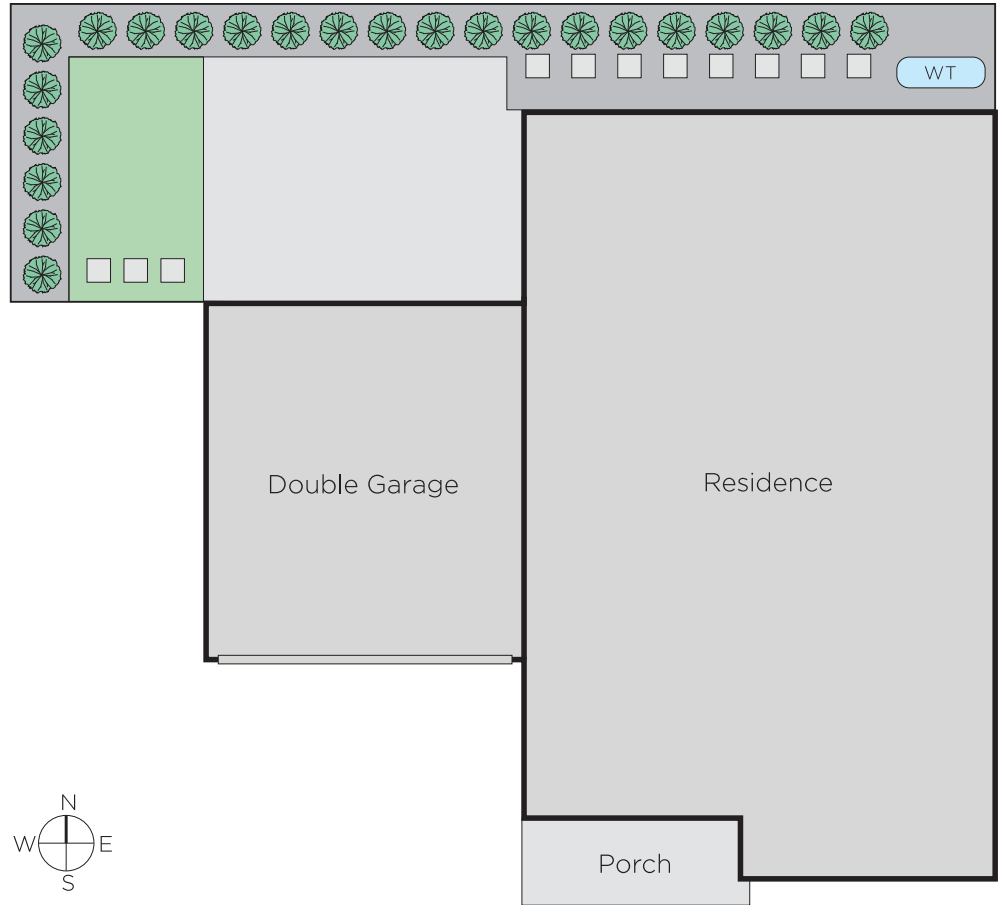
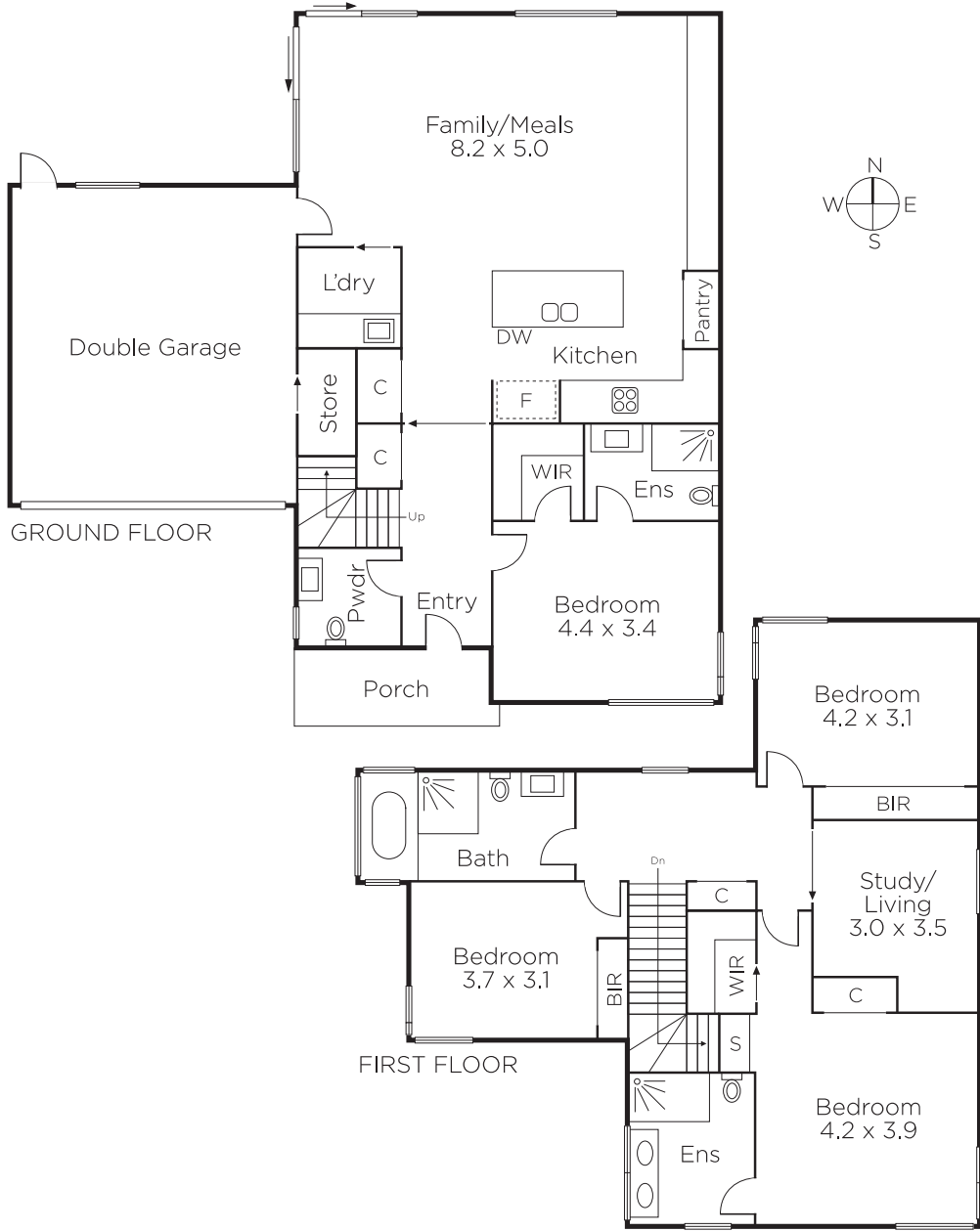

Disclaimer: Information provided is believed to be accurate as at the date of printing, no responsibility is taken for any errors or omissions. It is your responsibility to obtain independent, professional advice. Personal information collected from you is for security purposes and to contact you should the property sell prior to auction. We may use this information to provide you with other real estate services including referrals to authorised financial services' providers. Visit our website at www.marshallwhite.com.au for our privacy policy.