



MARSHALLWHITE

3/12 Tollington Avenue
Malvern East



Quality & Style Near Hedgeley Dene Gardens

This classic single freestanding level town residence, one of three, is perfectly placed at the rear providing a preferred quiet, secure & low maintenance living near Hedgeley Dene Gardens. The deceptively spacious, light-filled interior features living areas bathed in northern sunshine; with an entrance hall opening to a combined sitting/dining room plus an informal family room with a well-equipped kitchen & adjacent laundry leading to a sunny wrap-around courtyard garden with paved alfresco area. Complemented by 3-bedrooms, main with WIR/ensuite & a family bathroom. Incls. remote double garage with turning area.

3-12tollingtonavenue-malverneast.com

3 2 2

Auction Saturday 16th June at 2.30pm

David Volpato
0414 701 983

Hamish Tostevin
0408 004 766

Bernadette Kiraly
0401 656 052

MARSHALLWHITE

1111 High Street, Armadale

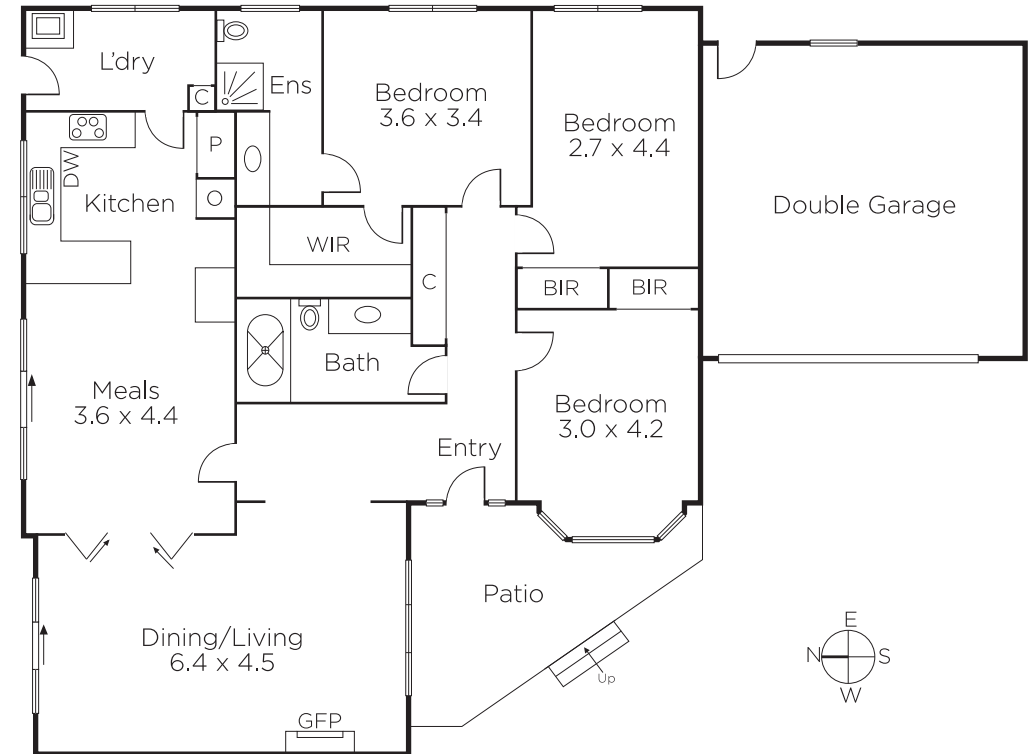

Disclaimer: Information provided is believed to be accurate as at the date of printing, no responsibility is taken for any errors or omissions. It is your responsibility to obtain independent, professional advice. Personal information collected from you is for security purposes and to contact you should the property sell prior to auction. We may use this information to provide you with other real estate services including referrals to authorised financial services providers. Visit our website at www.marshallwhite.com.au for our privacy policy.