



MARSHALLWHITE
ONE

310/96 Camberwell Road
Hawthorn East



Elmington; Two Bedroom plus Study

In a location loaded with lifestyle appeal, this two bedroom, two bathroom plus study apartment offers an exceptional low maintenance choice close to Camberwell Junction, Auburn Village and the Rivoli Cinema. French Oak herringbone laid flooring and stone finishes highlight attractive interiors including an open-plan living and dining domain with sliding doors opening to the balcony overlooking Fritsch Holzer Park. Smeg equipped kitchen with integrated dining table, master bedroom with ensuite and Juliet balcony plus secure video intercom, Euro laundry, second bathroom with rainfall shower heads, double glazing windows throughout, storage cage and secure basement parking further enhances the overall appeal of this home whilst year round comfort is achieved with reverse cycle AC in every room. Within walking distance to all modes of public transport, The Well Shopping Complex and Swinburne University.

310-96camberwellroad-hawthorneast.com 2 2 1

Private Sale

Danny See 0402 533 853

Kane Penhalluriack 0406 556 445

801 Glenferrie Road Hawthorn

9822 9999 mwone.com.au

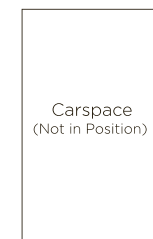
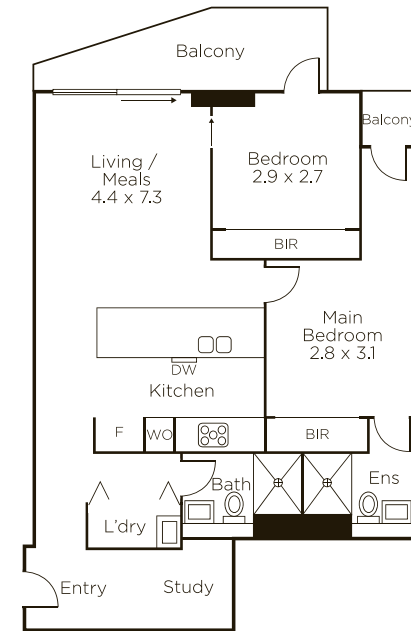

MARSHALLWHITE
ONE

Disclaimer: Information provided is believed to be accurate as at the date of printing, no responsibility is taken for any errors or omissions. It is your responsibility to obtain independent, professional advice. Personal information collected from you is for security purposes to contact you should the property sell prior to auction. We may use this information to provide you with other real estate services including referrals to authorized financial services' providers. Visit our website at www.mwone.com.au for our privacy policy.