



  
MARSHALLWHITE

3 Kyme Place  
Port Melbourne





## Vibrant Bayside Living

In a secluded cul de sac yet literally metres from Bay Street's shops and restaurants, this sensational contemporary residence's generous, light-filled and stylish interior delivers exceptional lock up and leave lifestyle rewards. A raked ceiling accentuates the sense of space in the open plan living/dining room featuring dark timber floors, an open fire and a recently renovated kitchen. Vaulted ceilings are continued through the two generous bedrooms fitted with robes and opening to a private BBQ terrace. A smart bathroom and Euro-laundry complete the fabulous floor-plan which also includes a lock-up garage.

2 1 1

Auction Saturday 17th November at 12.30pm

**Matthew Grima**  
0403 438 601

**Bradley Steinbach**  
0403 539 038

**Kaine Lanyon**  
0411 875 478

  
**MARSHALLWHITE**

101 Dundas Place, Albert Park

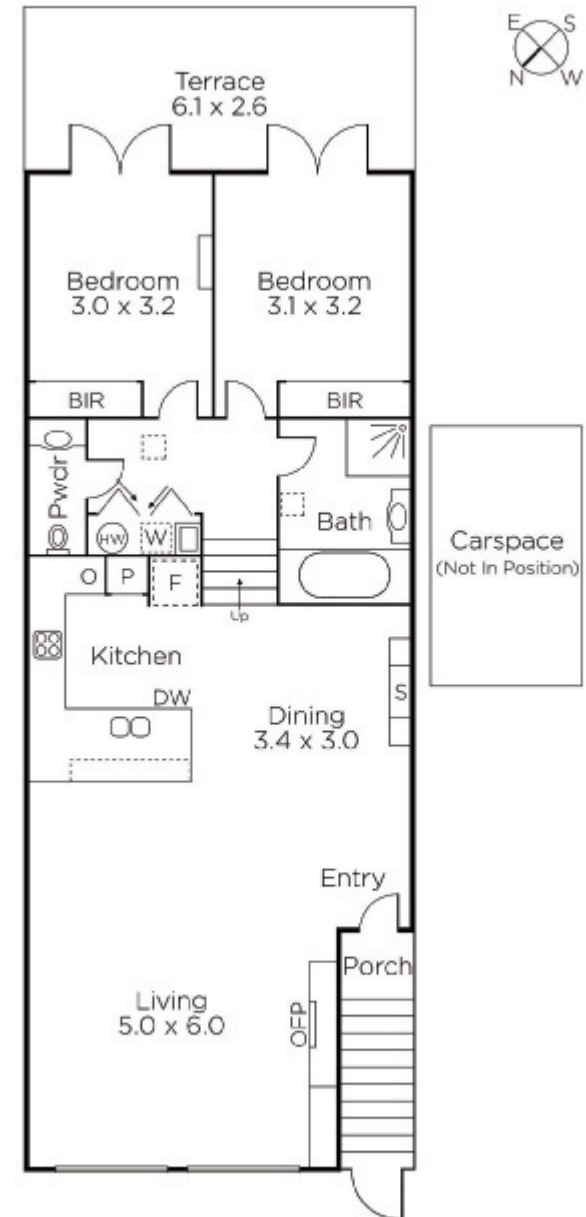

Disclaimer: Information provided is believed to be accurate as at the date of printing, no responsibility is taken for any errors or omissions. It is your responsibility to obtain independent, professional advice. Personal information collected from you is for security purposes and to contact you should the property sell prior to auction. We may use this information to provide you with other real estate services including referrals to authorised financial services providers. Visit our website at [www.marshallwhite.com.au](http://www.marshallwhite.com.au) for our privacy policy.