



MARSHALLWHITE

295 Richardson Street
Middle Park



Hawthorn Brick Heritage Victorian c1900

In one of Middle Park's most sought after heritage streetscapes, this gorgeous Hawthorn brick Victorian terrace was built at the turn-of-the-century and retains all of its period appeal. Stylishly appointed, its interiors reveal a traditional arched hallway preceding three inviting bedrooms, the main with a beautiful bay window. The central living room of pleasing proportions also features an open fireplace and flows through to a contemporary kitchen and dining area extending through French doors to a deep north facing garden with paved entertaining terrace. Family bathroom. 2nd WC. ROW access. Potential OSP.

295richardsonstreet-middlepark.com

3 1

Auction Saturday 24th June at 12.30pm

Adrian Wood 0404 861 508

Michael Paproth 0488 300 800

Sarah Carey 0420 246 200

101 Dundas Place Albert Park

marshallwhite.com.au



MARSHALLWHITE

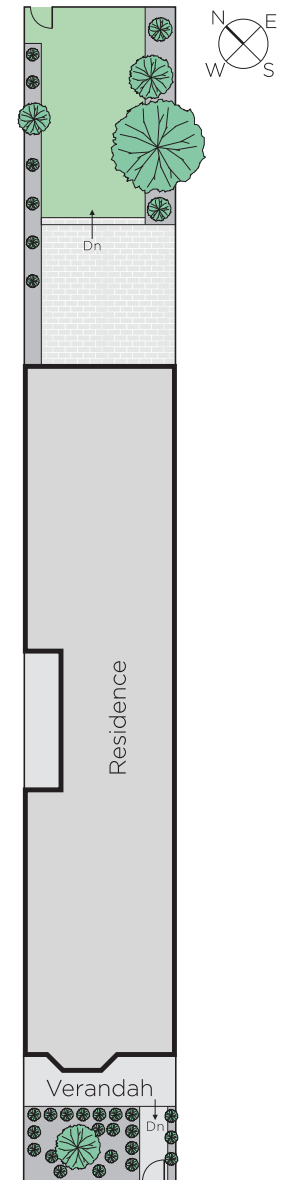
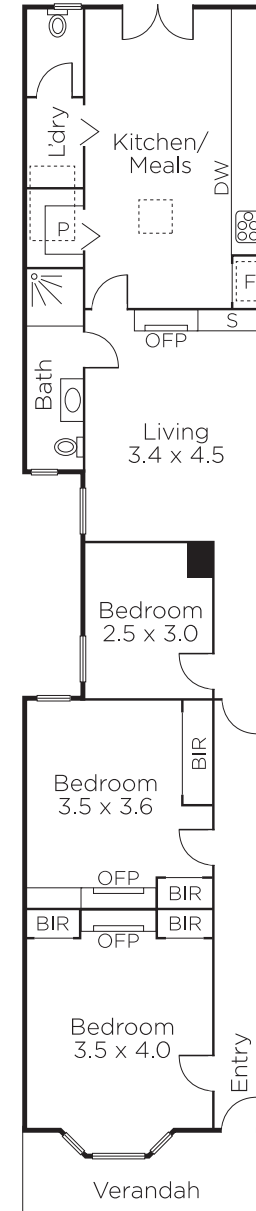

Disclaimer: Information provided is believed to be accurate as at the date of printing, no responsibility is taken for any errors or omissions. It is your responsibility to obtain independent, professional advice. Personal information collected from you is for security purposes and to contact you should the property sell prior to auction. We may use this information to provide you with other real estate services including referrals to authorised financial services' providers. Visit our website at www.marshallwhite.com.au for our privacy policy.