



MARSHALLWHITE

286 Richardson Street
Middle Park



Original Elegance, Outstanding Opportunity

Advantaged by a second frontage on Neville St, this classic freestanding Hawthorn brick Victorian residence offers a sensational blank canvas for an inspired renovation and extension literally metres from Middle Park Village, Albert Park Lake, the light rail, schools and the beach (STCA).

The arched hallway leads to a large main bedroom with marble open fire and Baltic pine floors, a second double bedroom with Baltic pine floors, open fire and built in robe, a third bedroom and bright bathroom. The capable kitchen and generous living/dining room open to the deep garden with garage accessed via Neville St. Land size: 250sqm approx.

286richardsonstreet-middlepark.com

3 1 1

Auction Saturday 27th May at 12.30pm

Damian O'Sullivan 0418 566 916

Nicholas Hoo 0435 728 272

Oliver Bruce 0409 856 599

101 Dundas Place Albert Park
marshallwhite.com.au

MARSHALLWHITE

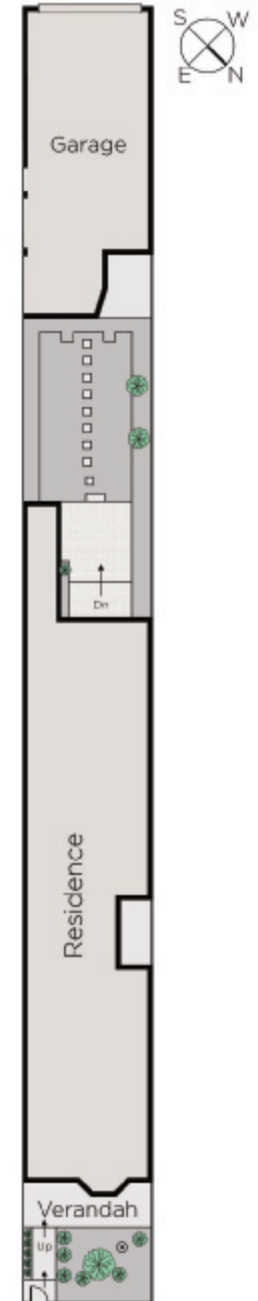

Disclaimer: Information provided is believed to be accurate as at the date of printing, no responsibility is taken for any errors or omissions. It is your responsibility to obtain independent, professional advice. Personal information collected from you is for security purposes and to contact you should the property sell prior to auction. We may use this information to provide you with other real estate services including referrals to authorised financial services' providers. Visit our website at www.marshallwhite.com.au for our privacy policy.