



MARSHALLWHITE

28 Redvers Street
Surrey Hills





Period Charm, Plentiful Proportions, Prized Location

Privately positioned in an exclusive cul-de-sac, surrounded by tranquil environs and exceptional period homes, this beautifully preserved c1926 Californian Bungalow poised on a substantial 794sqm approx. garden parcel is graced with traditional charm, surprising proportions and unlimited potential for personal improvement STCA, located moments from renowned amenities, parks and schools. Behind a quaint façade with porched entry, uncover distinguished details including Baltic Pine floors, intricate timber paneling and high ceilings on display throughout the homes functional multi-zoned layout. Comfortably comprising entrance hall, two generous, light-filled bedrooms, sumptuous formal dining and sitting room featuring two open fireplaces, elevated ceilings with impressive exposed beams and sunny garden aspects, informal lounge with wood fire heater, quality timber kitchen with meals area offering Smeg oven and Miele dishwasher, a separate study with in-built desk and adjoining sunroom, tiled central bathroom, third bedroom, paved alfresco entertaining area and backyard bordered by established gardens.

4  2  2 

Auction Saturday 1st December at 11.30am

Duane Wolowiec
0418 567 581

Shamit Verma
0401 137 597

MARSHALLWHITE
801 Glenferrie Road, Hawthorn

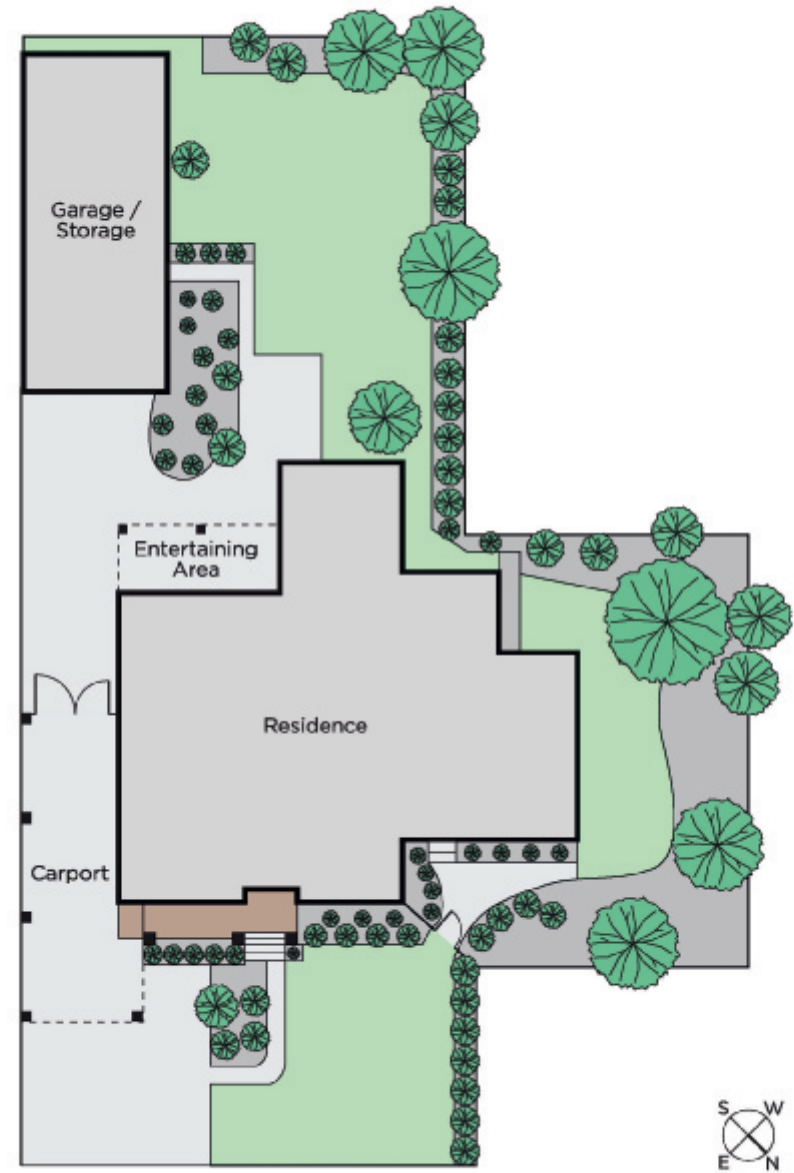
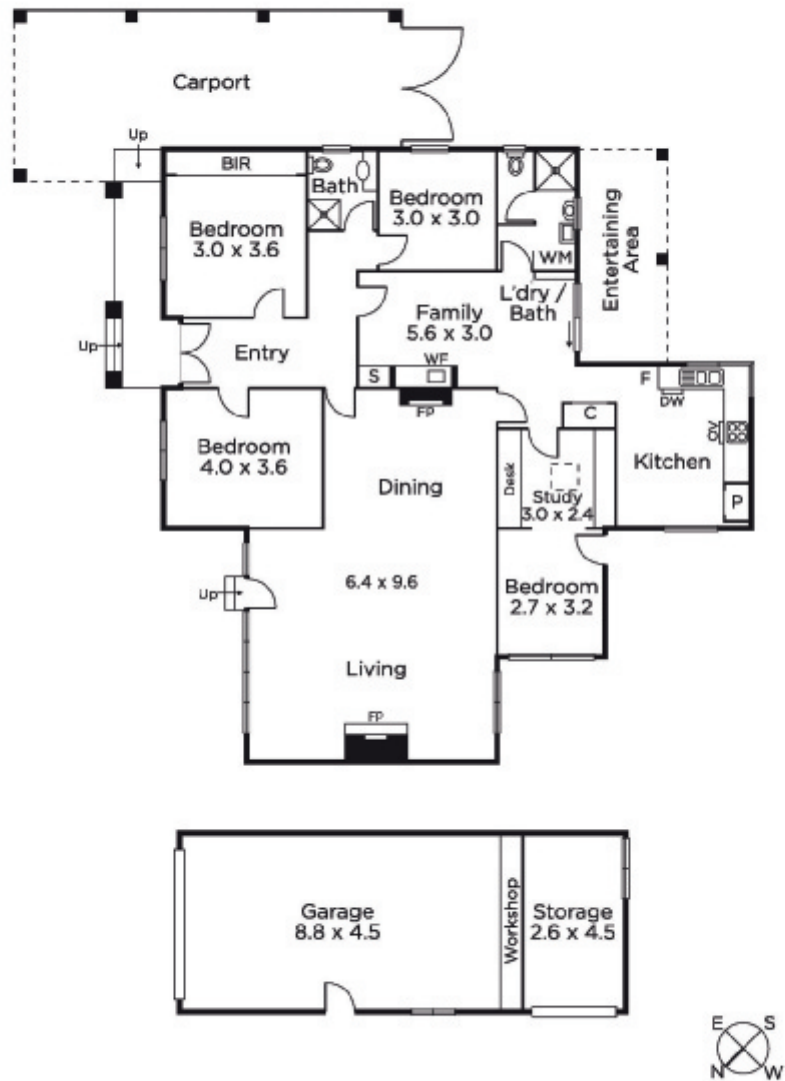

Disclaimer: Information provided is believed to be accurate as at the date of printing, no responsibility is taken for any errors or omissions. It is your responsibility to obtain independent, professional advice. Personal information collected from you is for security purposes and to contact you should the property sell prior to auction. We may use this information to provide you with other real estate services including referrals to authorised financial services' providers. Visit our website at www.marshallwhite.com.au for our privacy policy.